

Licensing (Licensing and Gambling) Sub-Committee

Thursday, 7th November, 2013
at 9.30 am

PLEASE NOTE TIME OF MEETING

Conference Room 3 - Civic
Centre

This meeting is open to the public

Members

Councillor Cunio
Councillor Lewzey
Councillor Parnell

Contacts

Democratic Support Officer
Karen Wardle
Tel: 023 8083 2302
Email: karen.wardle@southampton.gov.uk

Head of Legal, HR and Democratic Services
Richard Ivory
Tel. 023 8083 2794
Email: richard.ivory@southampton.gov.uk

PUBLIC INFORMATION

Terms of Reference

The Sub-Committee deals with licences for which the Council is responsible under the Licensing Act, 2003 and Gambling Act 2005, including:-

- Personal licences for the sale of liquor Licensing Act 2003;
- Premises licences, various permits, variations and reviews (Licensing Act 2003 and Gambling Act 2005);
- Club certificates, variations and reviews Licensing Act 2003;
- Registration and deregistration of designated premises supervisors Licensing Act 2003;
- Determination of police objections to temporary event notices Licensing Act 2003

Relevant Representations

Those who have made relevant representations may address the meeting about the matter in which they have an interest.

When dealing with Licensing Act matters the Sub-Committee can only take into account the following statutory Licensing Objectives:-

- prevention of crime and disorder
- public safety
- prevention of public nuisance
- protection of children from harm

Likewise, when dealing with Gambling Act matters the Sub Committee can only take into account the statutory Licensing Objectives below:-

- Preventing gambling being a source of crime
- That gambling is conducted in a fair and open way
- To protect children and other vulnerable children from harm

Smoking policy

The Council operates a no-smoking policy in all civic buildings.

Mobile Telephones –

Please turn off your mobile telephone whilst in the meeting.

Southampton City Council's Priorities:

- **Economic:** Promoting Southampton and attracting investment; raising ambitions and improving outcomes for children and young people.
- **Social:** Improving health and keeping people safe; helping individuals and communities to work together and help themselves.
- **Environmental:** Encouraging new house building and improving existing homes; making the city more attractive and sustainable.
- **One Council:** Developing an engaged, skilled and motivated workforce; implementing better ways of working to manage reduced budgets and increased demand.

Fire Procedure –

In the event of a fire or other emergency a continuous alarm will sound and you will be advised by Council officers what action to take.

Access –

Access is available for disabled people. Please contact the Democratic Support Officer who will help to make any necessary arrangements.

Dates of Potential Meetings Municipal Year 2013/14

2013	5TH DECEMBER
13TH JUNE	19TH DECEMBER
27TH JUNE	2014
11TH JULY	16TH JANUARY
25TH JULY	30TH JANUARY
8TH AUGUST	13TH FEBRUARY
22ND AUGUST	27TH FEBRUARY
5TH SEPTEMBER	13TH MARCH
19TH SEPTEMBER	27TH MARCH
3RD OCTOBER	10TH APRIL
17TH OCTOBER	24TH APRIL
7TH NOVEMBER	8TH MAY
21ST NOVEMBER	22ND MAY

CONDUCT OF MEETING

Terms of Reference

The terms of reference are contained in the Council's Constitution.

Business to be discussed

Only those items listed on the attached agenda may be considered at this meeting.

Rules of Procedure

The meeting is governed by the Council Procedure Rules as set out in Part 4 of the Constitution.

Quorum 3

The minimum number of appointed Members required to be in attendance to hold the meeting is 3.

DISCLOSURE OF INTERESTS

Members are required to disclose, in accordance with the Members' Code of Conduct, **both** the existence **and** nature of any "Disclosable Personal Interest" or "Other Interest" they may have in relation to matters for consideration on this Agenda.

DISCLOSABLE PERSONAL INTERESTS

A Member must regard himself or herself as having a Disclosable Pecuniary Interest in any matter that they or their spouse, partner, a person they are living with as husband or wife, or a person with whom they are living as if they were a civil partner in relation to:

(i) Any employment, office, trade, profession or vocation carried on for profit or gain.

(ii) Sponsorship:

Any payment or provision of any other financial benefit (other than from Southampton City Council) made or provided within the relevant period in respect of any expense incurred by you in carrying out duties as a member, or towards your election expenses. This includes any payment or financial benefit from a trade union within the meaning of the Trade Union and Labour Relations (Consolidation) Act 1992.

(iii) Any contract which is made between you / your spouse etc (or a body in which the you / your spouse etc has a beneficial interest) and Southampton City Council under which goods or services are to be provided or works are to be executed, and which has not been fully discharged.

(iv) Any beneficial interest in land which is within the area of Southampton.

(v) Any license (held alone or jointly with others) to occupy land in the area of Southampton for a month or longer.

(vi) Any tenancy where (to your knowledge) the landlord is Southampton City Council and the tenant is a body in which you / your spouse etc has a beneficial interests.

(vii) Any beneficial interest in securities of a body where that body (to your knowledge) has a place of business or land in the area of Southampton, and either:

- a) the total nominal value of the securities exceeds £25,000 or one hundredth of the total issued share capital of that body, or
- b) if the share capital of that body is of more than one class, the total nominal value of the shares of any one class in which you / your spouse etc has a beneficial interest that exceeds one hundredth of the total issued share capital of that class.

Other Interests

A Member must regard himself or herself as having a, 'Other Interest' in any membership of, or occupation of a position of general control or management in:

Any body to which they have been appointed or nominated by Southampton City Council

Any public authority or body exercising functions of a public nature

Any body directed to charitable purposes

Any body whose principal purpose includes the influence of public opinion or policy

Principles of Decision Making

All decisions of the Council will be made in accordance with the following principles:-

- proportionality (i.e. the action must be proportionate to the desired outcome);
- due consultation and the taking of professional advice from officers;
- respect for human rights;
- a presumption in favour of openness, accountability and transparency;
- setting out what options have been considered;
- setting out reasons for the decision; and
- clarity of aims and desired outcomes.

In exercising discretion, the decision maker must:

- understand the law that regulates the decision making power and gives effect to it. The decision-maker must direct itself properly in law;
- take into account all relevant matters (those matters which the law requires the authority as a matter of legal obligation to take into account);
- leave out of account irrelevant considerations;
- act for a proper purpose, exercising its powers for the public good;
- not reach a decision which no authority acting reasonably could reach, (also known as the "rationality" or "taking leave of your senses" principle);
- comply with the rule that local government finance is to be conducted on an annual basis. Save to the extent authorised by Parliament, 'live now, pay later' and forward funding are unlawful; and
- act with procedural propriety in accordance with the rules of fairness.

AGENDA

Agendas and papers are available via the Council's website.

1 ELECTION OF CHAIR

To appoint a Chair for the purposes of this meeting.

2 APOLOGIES AND CHANGES IN MEMBERSHIP (IF ANY)

To note any changes in the membership of the Sub-Committee made in accordance with the Licensing Act 2003.

3 DISCLOSURE OF PERSONAL AND PECUNIARY INTERESTS

In accordance with the Localism Act 2011, and the Council's Code of Conduct, Members to disclose any personal or pecuniary interests in any matter included on the agenda for this meeting.

NOTE: Members are reminded that, where applicable, they must complete the appropriate form recording details of any such interests and hand it to the Democratic Support Officer.

4 STATEMENT FROM THE CHAIR

5 MINUTES OF THE PREVIOUS MEETING (INCLUDING MATTERS ARISING)

To approve and sign as a correct record the Minutes of the meeting held on 17 October 2013 and to deal with any matters arising, attached.

6 EXCLUSION OF THE PRESS AND PUBLIC

At a predetermined point during the consideration of all items the Sub-Committee may move into private session in order to receive legal advice when determining issues. The press and the public, unless otherwise excluded by the Licensing Act 2003 (Hearings) Regulations 2005, will be invited to return immediately following that private session at which time the matter will be determined and the decision of the Sub-Committee will be announced.

7 APPLICATION TO VARY A PREMISES LICENCE - JUNK CLUB, 55 LONDON ROAD, SOUTHAMPTON SO15 2AD

Report of the Head of Legal, HR and Democratic Services, detailing an application to vary a premises licence in respect of Junk Club, 55 London Road, Southampton SO15 2AD, attached.

8 APPLICATION TO VARY A PREMISES LICENCE - GENTING CASINO TERMINUS TERRACE, TERMINUS HOUSE, TERMINUS TERRACE, SOUTHAMPTON SO14 3FE

Report of the Head of Legal, HR and Democratic Services, detailing an application to vary a premises licence in respect of Genting Casino Terminus Terrace, Terminus House, Terminus Terrace, Southampton SO14 3FE, attached.

WEDNESDAY, 30 OCTOBER 2013

HEAD OF LEGAL, HR AND DEMOCRATIC
SERVICES

SOUTHAMPTON CITY COUNCIL
LICENSING (LICENSING AND GAMBLING) SUB-COMMITTEE
MINUTES OF THE MEETING HELD ON 17 OCTOBER 2013

Present: Councillors Mrs Blatchford, Pope and Spicer

Apologies: Councillor Cunio

23. **ELECTION OF CHAIR**

RESOLVED that Councillor Mrs Blatchford be elected as Chair for the purposes of this meeting.

24. **APOLOGIES AND CHANGES IN MEMBERSHIP (IF ANY)**

The Sub-Committee noted that apologies had been received from Councillor Cunio and that Councillor Mrs Blatchford was in attendance as a nominated substitute in accordance with Procedure Rule 4.3.

25. **MINUTES OF THE PREVIOUS MEETING (INCLUDING MATTERS ARISING)**

RESOLVED that the minutes of the meeting held on 19 September 2013 be approved and signed as a correct record.

26. **EXCLUSION OF THE PRESS AND PUBLIC**

RESOLVED that in accordance with the Licensing Act 2003 (Hearings) Regulations 2005 that the press and public be excluded at a predetermined point whilst the Sub-Committee reach its decisions.

27. **APPLICATION FOR PREMISES LICENCE - DEVON STORE, 127 OBELISK ROAD, SOUTHAMPTON, SO19 9DN**

RESOLVED that the application be adjourned to 31 October 2013.

28. **APPLICATION TO VARY A PREMISES LICENCE - JUNK CLUB, 55 LONDON ROAD, SOUTHAMPTON, SO15 2AD**

RESOLVED that the application be adjourned to 7 November 2013.

29. **APPLICATION FOR PREMISES LICENCE - SHELL UK OIL PRODUCTS LTD, BASSETT AVENUE, SOUTHAMPTON, SO16 7LQ**

The Sub-Committee considered the application for a premises licence in respect of Shell UK Oil Products Ltd, Bassett Avenue, Southampton SO16 7LQ. (Copy of report circulated with the agenda and appended to the signed minutes)

Mr Charalambides (Counsel for applicant), Mr Lockett (Agent for applicant), Mr and Mrs Nicholson (local residents), PC Norris and PC Smith, Hampshire Constabulary were present and with the consent of the Chair, addressed the meeting.

The Sub-Committee considered the decision in confidential session in accordance with the Licensing Act (Hearings) Regulations 2005.

RESOLVED that the application for a premises licence be granted subject to the conditions agreed with police and the conditions agreed at the meeting.

After private deliberation the Sub-Committee reconvened and the Chair read the following decision with reasons (subject to discussion regarding conditions):-

The Sub-Committee has considered very carefully the application for a premises licence at Shell Bassett Avenue. It has given due regard to the Licensing Act 2003, the Licensing Objectives, statutory guidance and the adopted statement of Licensing Policy. Human rights legislation has been borne in mind.

It has considered very carefully all the evidence submitted by all parties, both written and given orally today, including the additional information supplied by the applicant.

The Sub-Committee heard an initial application by the applicant to consider the effect of the European Services Directive and in particular Regulation 19 relating to authorisation procedures and the time for dealing with applications. The Sub-Committee considered (i) the fact that notice had not been given to the applicant with the hearing notice, (ii) the fact that the hearing and consideration of the application had taken in excess of a year and (iii) that the matter had already been adjourned on two occasions. These factors, the applicant asserted, meant that the application could not now be heard and that the application should be deemed to have been granted in accordance with subsection 5. The Sub-Committee determined that the process was, however, justified by overriding reasons relating to the public interest, including a legitimate interest of third parties. It arrived at this conclusion on the basis that third parties, in this case, the police and residential objectors, were entitled to a fair hearing and an expectation that their objection would properly and fully be heard, accordingly to fail to hear the application in full could be a contravention of their Human Rights amounting to an overriding reason.

The Sub-Committee after careful consideration of all the factors has determined to grant the application subject to the following conditions:

- 1) The premises licence holder shall ensure that figures enabling the comparison of total turnover (excluding VAT) at the premises for fuel with convenience store goods are produced to the Licensing Authority at six-monthly intervals and covering the same period.
- 2) A minimum of two litter bins shall be placed on the forecourt of the premises. A minimum of two litter picks will take place per day to cover the forecourt area and the immediate vicinity of the premises.
- 3) The premises shall not be permitted to sell individual cans or bottles of lager, beer, cider or spirit mixer drinks and shall not sell, in any case, high strength lager, beer, cider or spirit mixer (in this instance "high strength" means drinks above 6.0% ABV).

In addition, the Sub Committee confirmed and imposed conditions that had been agreed between the applicant and the Police relating to CCTV, Incident book, Refusals book, Challenge 25 and training.

Reasons

The Sub-Committee listened carefully to the representations of residents and heard evidence presented by the applicant, including an explanation of figures produced. In addition the Sub-Committee heard evidence from the Police primarily in relation to the primary use of the premises as a garage.

It is noted that the applicant has on two previous occasions been required to produce figures relating to transactions by way of number with regards fuel purchases only, fuel and convenience purchases and convenience purchases only as well as comparison of turnover excluding VAT. It is further noted that the applicant has failed to produce that information despite on the last occasion, the Sub-Committee requesting only two weeks of figures. The Sub-Committee is extremely disappointed to be in the same position and without the information it has requested in accordance with the hearings regulations.

The Sub-Committee is, however, no longer willing to adjourn the application any further and has determined to make a decision based on the evidence that it has before it. On the basis of the statistics presented the Sub-Committee has no option other than to conclude that the primary use of the premises is not that of a garage. The statistics show that the highest proportion of turnover at the premises, excluding VAT relates to convenience store items and there is no evidence presented to the Sub-Committee to warrant an alternative determination at this time.

There is a right of appeal for all parties to the Magistrates' Court. All parties will receive written notification of the decision with reasons and that notification will set out the right of appeal in full.

30. **APPLICATION FOR PREMISES LICENCE - SHELL HAMPTON COURT, 197 BURGESS ROAD, SOUTHAMPTON, SO17 1TU**

The Sub-Committee considered the application for a premises licence in respect of Shell Hampton Court, 197 Burgess Road, Southampton SO17 1TU. (Copy of report circulated with the agenda and appended to the signed minutes)

Mr Charalambides (Counsel for applicant), Mr Lockett (Agent for applicant), PC Norris and PC Smith, Hampshire Constabulary were present and with the consent of the Chair, addressed the meeting.

The Sub-Committee considered the decision in confidential session in accordance with the Licensing Act (Hearings) Regulations 2005.

The issue being precisely the same (save for the lack of residential objection) as that determined in the previous agenda item, the Sub-Committee indicated it was minded to make a similar determination and invited representations. Both parties accepted the similarity and no objection was raised other than noting minor differences.

RESOLVED that the application for a premises licence be granted subject to the conditions agreed with police and the conditions agreed at the meeting. Further, that a similar decision to the former be imposed save for minor amendment as follows:

The Sub-Committee has considered very carefully the application for a premises licence at Shell Hampton Park. It has given due regard to the Licensing Act 2003, the Licensing Objectives, statutory guidance and the adopted statement of Licensing Policy. Human rights legislation has been borne in mind.

It has considered very carefully all the evidence submitted by all parties, both written and given orally today, including the additional information supplied by the applicant.

The Sub-Committee heard an initial application by the applicant to consider the effect of the European Services Directive and in particular Regulation 19 relating to authorisation procedures and the time for dealing with applications. The Sub-Committee considered (i) the fact that notice had not been given to the applicant with the hearing notice, (ii) the fact that the hearing and consideration of the application had taken in excess of a year and (iii) that the matter had already been adjourned on two occasions. These factors, the applicant asserted, meant that the application could not now be heard and that the application should be deemed to have been granted in accordance with subsection 5. The Sub-Committee determined that the process was, however, justified by overriding reasons relating to the public interest, including a legitimate interest of third parties. It arrived at this conclusion on the basis that third parties, in this case, the police were entitled to a fair hearing and an expectation that their objection would properly and fully be heard, accordingly to fail to hear the application in full could be a contravention of their interests amounting to an overriding reason.

The Sub-Committee after careful consideration of all the factors has determined to grant the application subject to the following conditions:

- 4) The premises licence holder shall ensure that figures enabling the comparison of total turnover (excluding VAT) at the premises for fuel with convenience store goods are produced to the Licensing Authority at six-monthly intervals and covering the same period.
- 5) A minimum of two litter bins shall be placed on the forecourt of the premises. A minimum of two litter picks will take place per day to cover the forecourt area and the immediate vicinity of the premises.
- 6) The premises shall not be permitted to sell individual cans or bottles of lager, beer, cider or spirit mixer drinks and shall not sell, in any case, high strength lager, beer, cider or spirit mixer (in this instance "high strength" means drinks above 6.0% ABV).

In addition, the Sub Committee confirmed and imposed conditions that had been agreed between the applicant and the Police relating to CCTV, Incident book, Refusals book, Challenge 25 and training.

Reasons

The Sub-Committee listened carefully to the representations of residents and heard evidence presented by the applicant, including an explanation of figures produced. In addition the Sub-Committee heard evidence from the Police primarily in relation to the primary use of the premises as a garage.

It is noted that the applicant has on two previous occasions been required to produce figures relating to transactions by way of number with regards fuel purchases only, fuel and convenience purchases and convenience purchases only as well as comparison of

turnover excluding VAT. It is further noted that the applicant has failed to produce that information despite on the last occasion, the Sub-Committee requesting only two weeks of figures. The Sub-Committee is extremely disappointed to be in the same position and without the information it has requested in accordance with the hearings regulations.

The Sub-Committee is, however, no longer willing to adjourn the application any further and has determined to make a decision based on the evidence that it has before it. On the basis of the statistics presented the Sub-Committee has no option other than to conclude that the primary use of the premises is not that of a garage. The statistics show that the highest proportion of turnover at the premises, excluding VAT relates to convenience store items and there is no evidence presented to the Sub-Committee to warrant an alternative determination at this time.

There is a right of appeal for all parties to the Magistrates' Court. All parties will receive written notification of the decision with reasons and that notification will set out the right of appeal in full.

This page is intentionally left blank

Agenda Item 7



Reference: 2013/01946/01SPRV

Hearing: **7th November 2013**

APPLICATION TO VARY A PREMISES LICENCE

Premises Name: Junk Club
 Premises Address: 55 London Road
 Southampton
 SO15 2AD

Application Date: 23rd August 2013
 Application Received Date: 23rd August 2013

Application Valid Date: 23rd August 2013

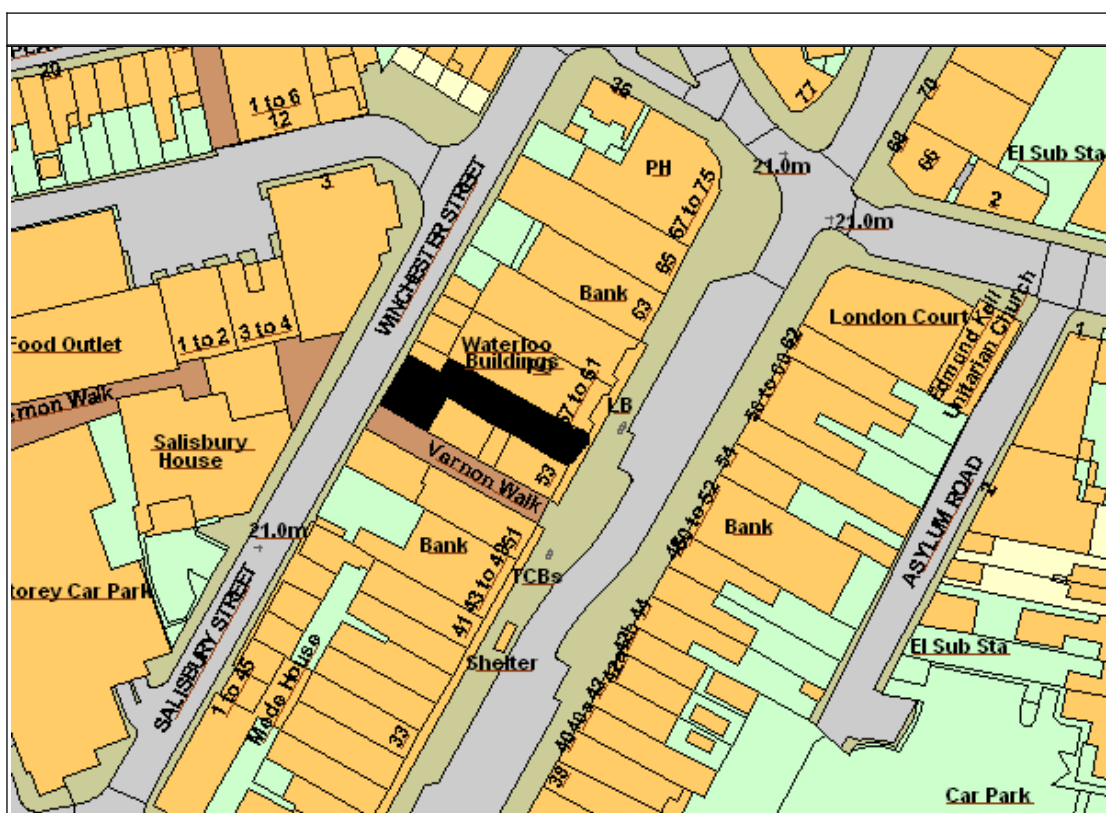

This map is reproduced from Ordnance Survey material with the permission of Ordnance Survey on behalf of the Controller of Her Majesty's Stationery Office © Crown copyright. Unauthorised reproduction infringes Crown copyright and may lead to prosecution or civil proceedings. Southampton City Council Licence No. 100019679 2007.

Representations From Responsible Authorities

Responsible Authority	Satisfactory?	Comments
Child Protection Services - Licensing	Yes	

Hampshire Fire And Rescue - Licensing	Yes	
Environmental Health - Licensing	Yes	
Primary Care Trust - Public Health Manager	No Response Received	
Planning & Sustainability - Development Control - Licensing	No Response Received	
Police - Licensing	No	
Trading Standards - Licensing	Yes	

Other Representations

Name	Address	Contributor Type
None	Received	

Legal Implications

1. The Licensing Act 2003 specifically restricts the grounds on which the Council, as Licensing Authority (LA), may refuse an application for a major variation of a Premises Licence, or impose conditions. Where relevant representations are made, the LA may refuse on the grounds that the licensing objectives are not met or the operating schedule is inadequate. Equally, conditions may be imposed where relevant and necessary. The LA may also refuse an application in part and thereby only permit some of the licensable activities sought.
2. The decision making committee, in considering an application, must have regard to the adopted Statement of Licensing Policy and any relevant representations made by those directly affected.
3. An applicant for a variation, whose application has been refused, or who is aggrieved by conditions imposed, may appeal against the decision to the Magistrates' Court.
4. In considering this application the committee will sit in a quasi-judicial capacity and is thus obliged to consider applications in accordance with both the Licensing Act 2003 (Hearings) Regulations 2005, and amending secondary legislation and the rules of natural justice. The practical effect of this is that the committee must make its decision based on evidence submitted in accordance with the legislation and give

adequate reasons for reaching it's decision.

The committee must also have regard to:-

5. *Crime and Disorder Act 1998*

Section 17 of the Crime and Disorder Act 1998 places the Council under a duty to exercise its various functions with due regard to the likely effect of the exercise of those functions on, and the need to do all that it reasonably can to prevent, crime and disorder in its area.

6. *Human Rights Act 1998*

The Act requires UK legislation to be interpreted in a manner consistent with the European Convention on Human Rights. It is unlawful for the Council to act in a way that is incompatible (or fail to act in a way that is compatible) with the rights protected by the Act. Any action undertaken by the Council that could have an effect upon another persons Human Rights must be taken having regard to the principle of Proportionality - the need to balance the rights of the individual with the rights of the community as a whole. Any action taken by the Council which affect another's rights must be no more onerous than is necessary in a democratic society. The matter set out in this report must be considered in light of the above obligations.

Southampton City Council

Application to vary a premises licence under the Licensing Act 2003

PLEASE READ THE FOLLOWING INSTRUCTIONS FIRST

Before completing this form please read the guidance notes at the end of the form.
 If you are completing this form by hand please write legibly in block capitals. In all cases ensure that your answers are inside the boxes and written in black ink. Use additional sheets if necessary.

You may wish to keep a copy of the completed form for your records.

I/We Mckinlay Holdings Ltd

(Insert name(s) of applicant)

being the premises licence holder, apply to vary a premises licence under section 34 of the Licensing Act 2003 for the premises described in Part 1 below

Premises licence number 2013/01324/01SPRT

Part 1 – Premises Details

Postal address of premises or, if none, ordnance survey map reference or description Junk Club 55 London Road			
Post town	Southampton	Post code	SO15 2AD

Telephone number at premises (if any)	02380 335511
Non-domestic rateable value of premises	£64500

Part 2 – Applicant details

Daytime contact telephone number	02380 335511
E-mail address (optional)	simon@junkclub.com
Current postal address if different from premises address	
Post Town	
Postcode	



Part 3 - Variation

Please tick yes

Do you want the proposed variation to have effect as soon as possible?

If not do you want the variation to take effect from

Day		Month		Year	
┆	┆	┆	┆	┆	┆

Please describe briefly the nature of the proposed variation (Please see guidance note 1)

To extend the opening hours of the venue, regulated entertainment and late night refreshment to 0430 Sunday to Friday, and 0530 on Saturdays

- To extend the supply of alcohol at the venue to 0400 Sunday to Friday and 0500 on Saturdays

To extend last entry into the venue to 0330 in line with other similar venues

- To introduce an exception to our current licensing condition regarding the use of polycarbonate glassware. This will specifically be to include the use of Corona and Desperados which are served traditionally in a bottle with a wedge of lime. There is no polycarbonate option available in the current marketplace. This will greatly help the business meet customer / market demand for the higher class clientele we wish to attract. This also applies to glass champagne glasses which will be permitted in the VIP area under supervision by doorstaff and served by a waitress. The products / brands will be approved in writing by the Hampshire Police Licensing Team.

If your proposed variation would mean that 5,000 or more people are expected to attend the premises at any one time, please state the number expected to attend

Part 4 Operating Schedule

Please complete those parts of the Operating Schedule below which would be subject to change if this application to vary is successful.

Provision of regulated entertainment

Please tick yes

- | | |
|--|-------------------------------------|
| a) plays (if ticking yes, fill in box A) | <input type="checkbox"/> |
| b) films (if ticking yes, fill in box B) | <input type="checkbox"/> |
| c) indoor sporting events (if ticking yes, fill in box C) | <input type="checkbox"/> |
| d) boxing or wrestling entertainment (if ticking yes, fill in box D) | <input type="checkbox"/> |
| e) live music (if ticking yes, fill in box E) | <input checked="" type="checkbox"/> |
| f) recorded music (if ticking yes, fill in box F) | <input checked="" type="checkbox"/> |
| g) performances of dance (if ticking yes, fill in box G) | <input checked="" type="checkbox"/> |
| h) anything of a similar description to that falling within (e), (f) or (g)
(if ticking yes, fill in box H) | <input type="checkbox"/> |

Provision of entertainment facilities:

- | | |
|--|-------------------------------------|
| i) making music (if ticking yes, fill in box I) | <input type="checkbox"/> |
| j) dancing (if ticking yes, fill in box J) | <input checked="" type="checkbox"/> |
| k) entertainment of a similar description to that falling within (i) or (j)
(if ticking yes, fill in box K) | <input type="checkbox"/> |

Provision of late night refreshment (if ticking yes, fill in box L)

Sale by retail of alcohol (if ticking yes, fill in box M)

In all cases complete boxes N, O and P

A

Plays Standard days and timings (please read guidance note 6)			Will the performance of a play take place indoors or outdoors or both – please tick (please read guidance note 2)	Indoors	<input type="checkbox"/>
				Outdoors	<input type="checkbox"/>
				Both	<input type="checkbox"/>
Day	Start	Finish	Please give further details here (please read guidance note 3)		
Mon					
Tue			State any seasonal variations for performing plays (please read guidance note 4)		
Wed					
Thur			Non standard timings. Where you intend to use the premises for the performance of plays at different times to those listed in the column on the left, please list (please read guidance note 5)		
Fri					
Sat					
Sun					

B

Films Standard days and timings (please read guidance note 6)			<u>Will the exhibition of films take place indoors or outdoors or both – please tick</u> (please read guidance note 2)	Indoors	<input type="checkbox"/>
				Outdoors	<input type="checkbox"/>
				Both	<input type="checkbox"/>
Day	Start	Finish	<u>Please give further details here</u> (please read guidance note 3)		
Mon					
			<u>State any seasonal variations for the exhibition of films</u> (please read guidance note 4)		
Tue					
			<u>Non standard timings. Where you intend to use the premises for the exhibition of films at different times to those listed in the column on the left, please list</u> (please read guidance note 5)		
Wed					
Thur					
Fri					
Sat					
Sun					

C

Indoor sporting events Standard days and timings (please read guidance note 6)			<u>Please give further details</u> (please read guidance note 3)
Day	Start	Finish	
Mon			
Tue			<u>State any seasonal variations for indoor sporting events</u> (please read guidance note 4)
Wed			<u>Non standard timings. Where you intend to use the premises for indoor sporting events at different times to those listed in the column on the left, please list</u> (please read guidance note 5)
Thur			
Fri			
Sat			
Sun			

D

Boxing or wrestling entertainments Standard days and timings (please read guidance note 6)			<u>Will the boxing or wrestling entertainment take place indoors or outdoors or both – please tick</u> (please read guidance note 2)	Indoors	<input type="checkbox"/>
				Outdoors	<input type="checkbox"/>
				Both	<input type="checkbox"/>
Day	Start	Finish	<u>Please give further details here</u> (please read guidance note 3)		
Mon					
Tue					
Wed			<u>State any seasonal variations for boxing or wrestling entertainment</u> (please read guidance note 4)		
Thur					
Fri			<u>Non standard timings. Where you intend to use the premises for boxing or wrestling entertainment at different times to those listed in the column on the left, please list</u> (please read guidance note 5)		
Sat					
Sun					

E

Live music Standard days and timings (please read guidance note 6)			Will the performance of live music take place indoors or outdoors or both – please tick (please read guidance note 2)	Indoors	<input checked="" type="checkbox"/>
				Outdoors	<input type="checkbox"/>
				Both	<input type="checkbox"/>
Day	Start	Finish	Please give further details here (please read guidance note 3) The venue periodically features live music		
Mon	11:00	04:30			
Tue	11:00	04:30	State any seasonal variations for the performance of live music (please read guidance note 4) on New Years Eve the licensable activities are now permitted until 04:00 on January 2 nd following the same format as on existing licence		
Wed	11:00	04:30			
Thur	11:00	04:30	Non standard timings. Where you intend to use the premises for the performance of live music at different times to those listed in the column on the left, please list (please read guidance note 5)		
Fri	11:00	04:30			
Sat	11:00	05:30			
Sun	11:00	04:30			

F

Recorded music Standard days and timings (please read guidance note 6)			<u>Will the playing of recorded music take place indoors or outdoors or both – please tick</u> (please read guidance note 2)	Indoors	<input checked="" type="checkbox"/>
				Outdoors	<input type="checkbox"/>
				Both	<input type="checkbox"/>
Day	Start	Finish	<u>Please give further details here</u> (please read guidance note 3) The venue has two floors providing amplified recorded music with a live DJ on the majority of occasions		
Mon	11:00	04:30			
Tue	11:00	04:30	<u>State any seasonal variations for the playing of recorded music</u> (please read guidance note 4) on New Years Eve the licensable activities are now permitted until 04:00 on January 2nd following the same format as on existing licence		
Wed	11:00	04:30			
Thur	11:00	04:30	<u>Non standard timings. Where you intend to use the premises for the playing of recorded music at different times to those listed in the column on the left, please list</u> (please read guidance note 5)		
Fri	11:00	04:30			
Sat	11:00	05:30			
Sun	11:00	04:30			

G

Performances of dance Standard days and timings (please read guidance note 6)			Will the performance of dance take place indoors or outdoors or both – please tick (please read guidance note 2)	Indoors	<input checked="" type="checkbox"/>
Day	Start	Finish		Outdoors	<input type="checkbox"/>
Mon	11:00	04:30	Please give further details here (please read guidance note 3) Professional dancers occasionally provide an accompaniment to live or recorded music on a dedicated stage area	Both	<input type="checkbox"/>
Tue	11:00	04:30			
Wed	11:00	04:30	State any seasonal variations for the performance of dance (please read guidance note 4) on New Years Eve the licensable activities are now permitted until 04:00 on January 2nd following the same format as on existing licence		
Thur	11:00	04:30			
Fri	11:00	04:30	Non standard timings. Where you intend to use the premises for the performance of dance at different times to those listed in the column on the left, please list (please read guidance note 5)		
Sat	11:00	05:30			
Sun	11:00	04:30			

H

Anything of a similar description to that falling within (e), (f) or (g) Standard days and timings (please read guidance note 6)			<u>Please give a description of the type of entertainment you will be providing</u>		
Day	Start	Finish	<u>Will this entertainment take place indoors or outdoors or both – please tick</u> (please read guidance note 2)	Indoors	<input type="checkbox"/>
Mon				Outdoors	<input type="checkbox"/>
				Both	<input type="checkbox"/>
Tue			<u>Please give further details here</u> (please read guidance note 3)		
Wed					
Thur			<u>State any seasonal variations for entertainment of a similar description to that falling within (e), (f) or (g)</u> (please read guidance note 4)		
Fri					
Sat			<u>Non standard timings. Where you intend to use the premises for the entertainment of a similar description to that falling within (e), (f) or (g) at different times to those listed in the column on the left, please list</u> (please read guidance note 5)		
Sun					

I

Provision of facilities for making music Standard days and timings (please read guidance note 6)			<u>Please give a description of the facilities for making music you will be providing</u>			
			<u>Will the facilities for making music be indoors or outdoors or both – please tick</u> (please read guidance note 2)			Indoors
			Outdoors			<input type="checkbox"/>
			Both			<input type="checkbox"/>
Day	Start	Finish	<u>Please give further details here</u> (please read guidance note 3)			
Mon						
Tue			<u>State any seasonal variations for the provision of facilities for making music</u> (please read guidance note 4)			
Wed						
Thur			<u>Non standard timings. Where you intend to use the premises for provision of facilities for making music at different times to those listed in the column on the left, please list</u> (please read guidance note 5)			
Fri						
Sat						
Sun						

K

Provision of facilities for entertainment of a similar description to that falling within i or j Standard days and timings (please read guidance note 6)			<u>Please give a description of the type of entertainment facility you will be providing</u>		
Day	Start	Finish	<u>Will the entertainment facility be indoors or outdoors or both – please tick</u> (please read guidance note 2)	Indoors	<input checked="" type="checkbox"/>
Mon				Outdoors	<input type="checkbox"/>
				Both	<input type="checkbox"/>
Tue			<u>Please give further details here</u> (please read guidance note 3)		
Wed					
Thur			<u>State any seasonal variations for the provision of facilities for entertainment of a similar description to that falling within i or j</u> (please read guidance note 4)		
Fri					
Sat			<u>Non standard timings. Where you intend to use the premises for the provision of facilities for entertainment of a similar description to that falling within i or j at different times to those listed in the column on the left, please list</u> (please read guidance note 5)		
Sun					

L

Late night refreshment Standard days and timings (please read guidance note 6)			<u>Will the provision of late night refreshment take place indoors or outdoors or both – please tick</u> (please read guidance note 2)	Indoors	<input checked="" type="checkbox"/>
				Outdoors	<input type="checkbox"/>
				Both	<input type="checkbox"/>
Day	Start	Finish			
Mon	23:00	04:30	<u>Please give further details here</u> (please read guidance note 3) To be able to serve hot drinks from the venue		
Tue	23:00	04:30			
Wed	23:00	04:30	<u>State any seasonal variations for the provision of late night refreshment</u> (please read guidance note 4) on New Years Eve the licensable activities are now permitted until 04:00 on January 2nd following the same format as on existing licence		
Thur	23:00	04:30			
Fri	23:00	04:30	<u>Non standard timings. Where you intend to use the premises for the provision of late night refreshment at different times, to those listed in the column on the left, please list</u> (please read guidance note 5)		
Sat	23:00	05:30			
Sun	23:00	04:30			

M

Supply of alcohol Standard days and timings (please read guidance note 6)			Will the supply of alcohol be for consumption (Please tick box) (please read guidance note 7)	On the premises	<input type="checkbox"/>
				Off the premises	<input type="checkbox"/>
				Both	<input checked="" type="checkbox"/>
Day	Start	Finish	State any seasonal variations for the supply of alcohol (please read guidance note 4) on New Years Eve the licensable activities are now permitted until 04:00 on January 2nd following the same format as on existing licence Non-standard timings. Where you intend to use the premises for the supply of alcohol at different times to those listed in the column on the left, please list (please read guidance note 5)		
Mon	10:00	04:00			
Tue	10:00	04:00			
Wed	10:00	04:00			
Thur	10:00	04:00			
Fri	10:00	04:00			
Sat	10:00	05:00			
Sun	10:00	04:00			

N

Please highlight any adult entertainment or services, activities, other entertainment or matters ancillary to the use of the premises that may give rise to concern in respect of children (please read guidance note 8)

J

Provision of facilities for dancing Standard days and timings (please read guidance note 6)			<u>Will the facilities for dancing be indoors or outdoors or both – please tick</u> (see guidance note 2)	Indoors <input checked="" type="checkbox"/>
				Outdoors <input type="checkbox"/>
				Both <input type="checkbox"/>
			<u>Please give a description of the facilities for dancing you will be providing</u> Customers may wish to dance to recorded or live music provided by DJs / Live Artists	
Day	Start	Finish		
Mon	11:00	04:30	<u>Please give further details here</u> (please read guidance note 3) Areas where amplified music is played	
Tue	11:00	04:30		
Wed	11:00	04:30	<u>State any seasonal variations for providing dancing facilities</u> (please read guidance note 4) on New Years Eve the licensable activities are now permitted until 04:00 on January 2nd following the same format as on existing licence	
Thur	11:00	04:30		
Fri	11:00	04:30	<u>Non standard timings. Where you intend to use the premises for the provision of facilities for dancing at different times to those listed in the column on the left, please list</u> (please read guidance note 5)	
Sat	11:00	05:30		
Sun	11:00	04:30		

O

Hours premises are open to the public Standard days and timings (please read guidance note 6)			<u>State any seasonal variations</u> (please read guidance note 4)
Day	Start	Finish	
Mon	10:00	04:30	
Tue	10:00	04:30	
Wed	10:00	04:30	
Thur	10:00	04:30	
Fri	10:00	04:30	<u>Non standard timings. Where you intend the premises to be open to the public at different times from those listed in the column on the left, please list</u> (please read guidance note 5)
Sat	10:00	05:30	
Sun	10:00	04:30	

Please identify those conditions currently imposed on the licence which you believe could be removed as a consequence of the proposed variation you are seeking
 We are not looking to remove any of our current conditions except the provision of glass bottles as provide for on page 2 of this application

Please tick yes

- I have enclosed the premises licence
- I have enclosed the relevant part of the premises licence

If you have not ticked one of these boxes please fill in reasons for not including the licence, or part of it, below

Reasons why I have failed to enclose the premises licence or relevant part of premises licence

P Describe any additional steps you intend to take to promote the four licensing objectives as a result of the proposed variation:

a) General – all four licensing objectives (b,c,d,e) (please read guidance note 9)

- Adopt the best practice for training recommended by the Hampshire Police Licensing Authority
- Support the new Police Scheme which accredits venues for their welfare and safety policies.
- This will also include a training session given by a member of the Licensing team on a 6 monthly basis.
- Introduce an identification receipt system for seized ID's
- Ensure a written dispersal policy is in place and approved by Hampshire Police
- All in-house staff shall undergo an online licensing accreditation procedure approved by Hampshire police within 4 weeks of their start date
- Toilet checks will be added to the licensing conditions and will include checks every 30 minutes and recorded in the incident book and kept for a minimum of 3 months
- We also believe that by extending our licence in this way will bring us in line with other clubs in other cities of a similar type who also promote Internationally renowned DJs and Artists. The Artists we currently book and will be able to book will attract discerning music loving clientele into the area rather than simply cheap drink orientated customers. These Acts and Artists in turn promote Southampton as a cultural destination which raises the profile of the city. We have been successfully operating temporary event notices until 6am for many years without objection from the responsible authorities.

b) The prevention of crime and disorder

- The venue has a dedicated SIA Trained security team along with CCTV with clearly visible signs.
- The venue operates with a strict door entry policy which ensures the venue has an excellent level of clientele. This in turn ensures a very low level of crime and disorder.
- Doorstaff often help Hampshire Constabulary with incidents in the local area (positive intervention).
- Participation in the Southampton Licensing Link scheme, including the Red Card and use of ID scanner.
- Use of tall Heras fence barriers and tarpaulin to segregate and protect customers in the smoking area from vagrants and potentially unruly passers by.

c) Public safety

- The venue will have a dedicated medical room for the purposes of administering first aid. A first aid treatment box will be available and kept maintained. Persons identified as vulnerable will be taken to the room where enquiries can be conducted to ensure their safety.
- On Fridays, Saturdays and special events the venue will provide a First Aider qualified to minimum Emergency First Aid at Work level and the DPS will ensure the First Aider's qualification is valid.
- A member of staff will be employed to patrol and monitor customers for signs and/or symptoms of excess alcohol consumption. Anyone suspected of consuming excess amounts of alcohol will be taken to the first aid room. The club nanny will monitor persons purchasing alcohol to check they are not mixing multiple shots or measures together to ensure responsible alcohol consumption. A record will be maintained providing details of persons attended to, date, time, along with with the members of staff involved.
- All staff including bar staff and security have been trained in fire safety by a certified company
- The public toilets within the premises shall be checked every 30 minutes when the premises are open for a licensable activity. A record shall be kept by the premises for a period of 3

months for inspection by Hampshire Constabulary.

- Staff will be trained regarding appropriate precautions to prevent the sale of alcohol to persons under the age of 18, crime scene management, vulnerability, the signs and symptoms of drunk persons and the refusal of sale due to intoxication. Records will be kept of such training which must be signed and dated by the member of staff who has received that training.
- All staff will receive refresher training which should be signed and dated by the member of staff who received that training
- In addition to their training a written test related to the training will be conducted before the staff member is permitted to sell or authorise alcohol sales. The test will consist of a minimum of ten questions of which the pass rate should be 80%. Anyone who fails to reach the prescribed pass rate will be retrained and retested. Anyone not attaining the pass rate will not be permitted to sell or authorise the sale of alcohol until the pass rate is attained. There will be a minimum of 2 sets of questions to be used in the training which will be rotated upon each subsequent six month training session.
- All training records will be made immediately available for inspection by Hampshire Constabulary and any other responsible authority and kept on the licensed premises for a period of 2 years

d) The prevention of public nuisance

- The venue already has a dispersal policy in the conditions to the satisfaction of the Hampshire Constabulary, and goes above and beyond what is expected by providing the Police with positive intervention assistance in the London Road area
 - Door supervisors will remove all bottles and glasses from any customers attempting to leave the venue carrying such items
 - Doorstaff wearing high visibility armbands will patrol the venue at the end of each night for a period of 30 minutes or until such persons are dispersed from the area to ensure the safe and quiet dispersal of customers. Any customers congregating or loitering outside the venue after leaving the premises will be asked to depart quickly and quietly
- Notices will continue to be displayed in prominent positions at the exit of the premises requesting customers to leave quickly and quietly.
- During the last 30 minutes of trading the service points at the bar will be reduced and staff reallocated to collect glasses
- When the bar closes the lighting levels will be increased to encourage the gradual dispersal of customers in the bar area
- Music will be lowered in volume in the last 15 minutes of trading, so that for those customers that remain it will send out a clear message that the venue is preparing to close and to encourage customers to be ready to leave
- The venue is part of the Licensing link and Red Card scheme which ensures it shares information about troublesome individuals with the rest of the licensees

e) The protection of children from harm

- The venue uses an ID scanner already provided in the existing licence conditions with the Challenge 25 policy and the doorstaff in addition also handcheck all ID's.
- SIA trained and experienced doorstaff are used throughout the venue including the front door

Please tick yes

- I have made or enclosed payment of the fee
- I have sent copies of this application and the plan to responsible authorities and

others where applicable

- I understand that I must now advertise my application
- I have enclosed the premises licence or relevant part of it or explanation
- I understand that if I do not comply with the above requirements my application will be rejected

IT IS AN OFFENCE, LIABLE ON CONVICTION TO A FINE UP TO LEVEL 5 ON THE STANDARD SCALE, UNDER SECTION 158 OF THE LICENSING ACT 2003 TO MAKE A FALSE STATEMENT IN OR IN CONNECTION WITH THIS APPLICATION

Part 5 – Signatures (please read guidance note 10)

Signature of applicant (the current premises licence holder) or applicant's solicitor or other duly authorised agent (please read guidance note 11). If signing on behalf of the applicant please state in what capacity.

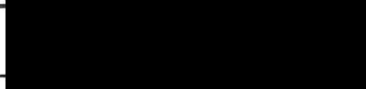
Signature	
Date	23/08/13
Capacity	Managing Director

Where the premises licence is jointly held signature of 2nd applicant (the current premises licence holder) or 2nd applicant's solicitor or other authorised agent (please read guidance note 12). If signing on behalf of the applicant please state in what capacity.

Signature	
Date	
Capacity	

Contact name (where not previously given) and address for correspondence associated with this application (please read guidance note 13)

Post town		Post code	
Telephone number (if any)			
If you would prefer us to correspond with you by e-mail your e-mail address (optional)			

Notes for Guidance

This application cannot be used to vary the licence so as to extend the period for which the licence has effect or to vary substantially the premises to which it relates. If you wish



HAMPSHIRE CONSTABULARY

G88

Page 1 of 6



NEW GRANT OR VARIATION OF PREMISES LICENCE OR CLUB PREMISES CERTIFICATE FORM FOR REPRESENTATIONS FROM HAMPSHIRE CONSTABULARY

Before completing this form please read the guidance notes on page 3.
Once completed please send your representation form to your local Licensing Authority.
You must keep a copy of the completed form for police records.

Hampshire Constabulary wish to make a representation(s) regarding the grant or variation of a
Premises Licence or Club Premises Certificate issued under the Licensing Act 2003.
These representations must be made within 28 days

Postal address of premises or club premises:			
Junk Club 55 London Road			
Post town:	Southampton	Postcode:	SO15 2AD

Name of premises licence holder or club holding club premises certificate (if known)
Mckinlay Holdings Ltd

Police Details

Hampshire Constabulary is a responsible authority.

Name and address: PC 24288 Harris Southampton Central Police Station Southern Road Southampton SO15 1AN

This application to object relates to the following licensing objective(s)

- 1) The prevention of crime and disorder
- 2) Public safety
- 3) The prevention of public nuisance
- 4) The protection of children from harm

Please select
one or more
boxes





HAMPSHIRE CONSTABULARY

Page 2 of 6



NEW GRANT OR VARIATION OF PREMISES LICENCE OR CLUB PREMISES CERTIFICATE FORM FOR REPRESENTATIONS FROM HAMPSHIRE CONSTABULARY

State the ground(s) for representation *(please read guidance notes 1 & 2)*

This representation relates to Junk Club, which is situated in London Road. The premises is located in one of the areas of Southampton, subject to a policy of cumulative impact as detailed in the present Statement of Licensing Policy 2011-2014, issued by Southampton City Council as the licensing authority.

The area of concern in this particular case is the Bedford Place Stress Area, which based on evidence previously received by Southampton City Council, is one of 3 areas that already suffers cumulative impact. As a result it is appropriate, proportionate and necessary for special policies to address that issue.

As per paragraph 16.7 of the Statement of Licensing Policy, Hampshire Police make representations on the basis that the applicant is applying for a significant variation to the premises existing licence. The applicant has applied to extend the premises opening hours by 1.5 hours every Saturday and 30 minutes every other day of the week. This in total provides the premises with a total of 4.5 hours of extended trading time per week or 234 hours over the course of a year. The applicant requests to extend the supply by retail of alcohol by the same increment although supply would cease as it does at the moment, half an hour before the closing time. Licensable activities such as recorded music and live music, the applicant seeks to extend these and keep them in line with the proposed opening hours.

The venue has submitted 9 temporary event notices (TEN) so far this year to extend its operating hours and licensable activities to 06:00 hours on 13 nights it was trading. However, it has been noted that of those 13 nights, only 6 occasions did the premises remain open until 06:00 hours and 1 night to 05:00 on a Saturday. On another occasion, the venue still closed at 04:00 and the other TEN's have occurred on other nights of the week. Although there has not been many incidents linked to Junk near to the 06:00 closing on a Sunday morning, six occasions is quite different to the 52 occasions that the extension to the licence would provide.

The police would suggest that the temporary events have only occurred on select nights. A bank holiday weekend or when a particular DJ is in attendance. People will not generally hear about the extended opening times unless it is a particular DJ they follow in comparison to the venue having an extension to its licence every night of the week. A TEN limits the amount of people that can attend to 499, which includes all its staff. Whereas the capacity for the venue is 750, an increase of 50%. There are other factors that make the application more significant. The venue wishes to extend its last entry from 02:30 to 03:30. This will likely attract further crowds that are leaving other venues and likely to be well under the influence of alcohol. This will place a heavy burden on the door security team at the venue in assessing who is fit or not fit for entry. The police anticipate, that by extending the venues hours and increasing the hours alcohol is available for consumption, on the balance of





HAMPSHIRE CONSTABULARY



**NEW GRANT OR VARIATION OF PREMISES LICENCE
OR CLUB PREMISES CERTIFICATE
FORM FOR REPRESENTATIONS FROM HAMPSHIRE CONSTABULARY**

probabilities this will only add to crime and disorder already experienced in the area.

The graph in annex a shows reported incidents in the demographic beat area of 1SW03 over three different years. As the Cumulative Impact Policy (CIP) was applied to the city in May 2009, the report shows crime reporting trends a year before the introduction of the CIP and then comparisons can be made between 2010 - 2011 and 2012 to 2013. The search criteria takes into account crimes of wounding, robbery - personal, public order, offensive weapon, indecent assault, drug offences, criminal damage, assault on police and assault. Regardless of year, the graph clearly shows the detrimental effect the night time economy and alcohol has on crime reporting. In each of the years evidenced, it shows a steady increase in crime reporting from 22:00 until 03:00 hours, with a dramatic drop between 05:00 - 06:00, when the majority of licensed premises are closed. Between 2010 and 2011, the area did become far more popular for a night out and this can be evidenced by the increase in crimes between 23:00 - 04:00 hours. The main concern to be drawn from the graph is there is far more crime being reported in the early hours of the morning in 2012 - 2013 than there was in 2008 - 2009. Between 03:00 - 05:00, we are seeing an increase of nearly 50% of the crimes highlighted above when compared to crime reported in 2008. As to whether the CIP has worked in this area is hard to say. As mentioned, the area did become much more popular for a night out, so taking this into account, its probably fair to say it has prevented it from getting any worse. If you compare the crimes reported in 2008 between 18:00 and 06:00, there were 732 reported in 2008-2009 compared to 837 reported between 2012 and 2013.

Annex b provides a list of occurrences that have been linked directly to Junk since the turn of the year. They are linked, as the occurrences would have occurred in the venue or involved its clientele. Most of the incidents have happened between the hours of 02:00 and 04:00, which is the last two hours the premises is normally open. People in general are coming out later at night than they used to and they will stay out later if the premises are open to cater for them into the early hours. By providing premises with even later opening times will only exasperate the problem and we will see further increases in crime in the early hours of the morning.

The applicant has advised that as part of the additional steps they intend to take to promote the four licensing objectives they will include supporting the police in its new scheme, which accredits venues for their welfare and safety policies. This scheme is still in the process of being produced and will have set criteria that venues will have to meet in order to be eligible. Until it is agreed as to what the criteria is, we cannot say whether or not the scheme would be offered to Junk.

The applicant has stated that "the venue operates a strict door entry policy which ensures the venue has an excellent level of clientele and in turn ensures a very low level of crime and disorder". The police have passed praise to the door team for having caught a number of its clientele with drugs over the past year. Annex b shows that 10 of the occurrences listed were drug related. Occurrence 20 was excellent work by door staff, as they stopped a male upon entry to the venue. He was later identified as a London based drug dealer who had on him around 30 mixed wraps of cocaine, MDMA and ketamine. Two class a drugs and a class c drug which were intended to be sold in the venue. Occurrence 25 provides details about a group of males located in the toilets of the venue by door staff.





HAMPSHIRE CONSTABULARY



NEW GRANT OR VARIATION OF PREMISES LICENCE OR CLUB PREMISES CERTIFICATE FORM FOR REPRESENTATIONS FROM HAMPSHIRE CONSTABULARY

It is again good work by the door team, as the suspect had enough MDMA in separate wraps to be charged with possession with intent to supply. The other 8 occurrences relate to general possession of drugs including MDMA, amphetamine/speed, ketamine and heroin. Of note, one of the arrested used to be a resident DJ at the venue. As much as the venue can be congratulated for its work in identifying these offenders, it does raise concerns regarding the venues clientele that it attracts. The drugs found on the offenders above, the majority have been linked with the club and rave scene for years. Annex c details a visit to the venue by PC Conway and PS Plascott on 01/03/13. The bar manager informed the officers their was an incident which involved the main act who were performing at the venue. The head doorman had gone into the toilet and caught one of the group snorting cocaine of his arm.

There are a number of other occurrences listed in annex b which raise concern about the venues clientele or certainly would go against the applicants suggestion that they are excellent. In occurrence 11, a male is assaulted by another and the offender bites through his lip. The offender has since been charged with causing grievous bodily harm (GBH). Occurrence 8, relates to 3 door staff being assaulted as does occurrence 9. Occurrence 15 details an assault on the manager of the venue. The manager was punched in the face as he tried to stop a customer from stealing a bottle of Vodka and Rum. Occurrence 1 relates to criminal damage to the designated premises supervisors (DPS) vehicle. A male in the smoking area throws a shoe which hits the bonnet.

Under the prevention of crime and disorder in the operating schedule, the applicant has listed a number of ways they intend on promoting the licensing objectives. This is nothing different to what they do already so there is no reason to suspect anything different if the venue was to operate to a later time.

The applicant also wishes to bring in an exception to its current condition relating to serving drinks in polycarbonate glasses. We do not have concerns with regards to the exception of champagne glasses being permitted within the VIP area, however, we do not consider that there is any evidence to suggest that Corona or Desperados will attract a higher class of clientele as stated by the applicant. Empty glass bottles can easily be used as a weapon during an altercation, with glass more likely to cause serious injury and permanent disfigurement.

It is on the above grounds that the police wish to object to the proposed variations. Any extension in hours is likely to add to problems already experienced in an area, highly saturated with licensed premises.

State any conditions that the Police seek to negate the need for a hearing

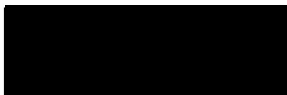



HAMPSHIRE CONSTABULARY



**NEW GRANT OR VARIATION OF PREMISES LICENCE
OR CLUB PREMISES CERTIFICATE
FORM FOR REPRESENTATIONS FROM HAMPSHIRE CONSTABULARY**

[Empty rectangular box for representations]

IT IS AN OFFENCE, UNDER SECTION 158 OF THE LICENSING ACT 2003 TO MAKE A FALSE STATEMENT IN OR IN CONNECTION WITH THIS REPRESENTATION

Part 3 – Signatures *(please read guidance note 3)*

Recommendation of Police Officer

The premises is situated in an area saturated by licensed premises. It can be evidenced that there is a strong link between the night time economy, alcohol and increased crime. The trend over the years shows that people are coming out later and the venues wish to follow suit. As a result of people coming out later, we have seen a dramatic increase in crime in the early hours and any extension to premises licence, will only exasperate the problem. I request the application is refused.

Signature of Police Officer Completing

Signature:

Date: 17/09/13

Recommendation of Police Sergeant

I fully support this objection as this premises is the latest venue in the area already and to increase its hours will encourage other premises to apply for later hours also, all of which will have a dramatic effect on the CIP.

Signature of Police Sergeant





HAMPSHIRE CONSTABULARY



**NEW GRANT OR VARIATION OF PREMISES LICENCE
OR CLUB PREMISES CERTIFICATE
FORM FOR REPRESENTATIONS FROM HAMPSHIRE CONSTABULARY**

Signature:

Date: 17/09/13

Decision of Police Licensing Inspector

I fully endorse the objection, this is a CIP area and this venue already has a closing time that is late compared to others. An increase in hours will have a dramatic effect to the detriment of the area which will work against the CIP.

Signature of Police Licensing Inspector

Signature:

Inspector 2841 Justin ROSSETZC

Date: 20/09/13

NOTES FOR GUIDANCE

1. The ground(s) for representation must be based on one of the licensing objectives.
2. Please list any additional information or details, for example dates of problems which are included in the grounds for representation if available.
3. The representation form must be signed.



Reported incidents in 1SW03

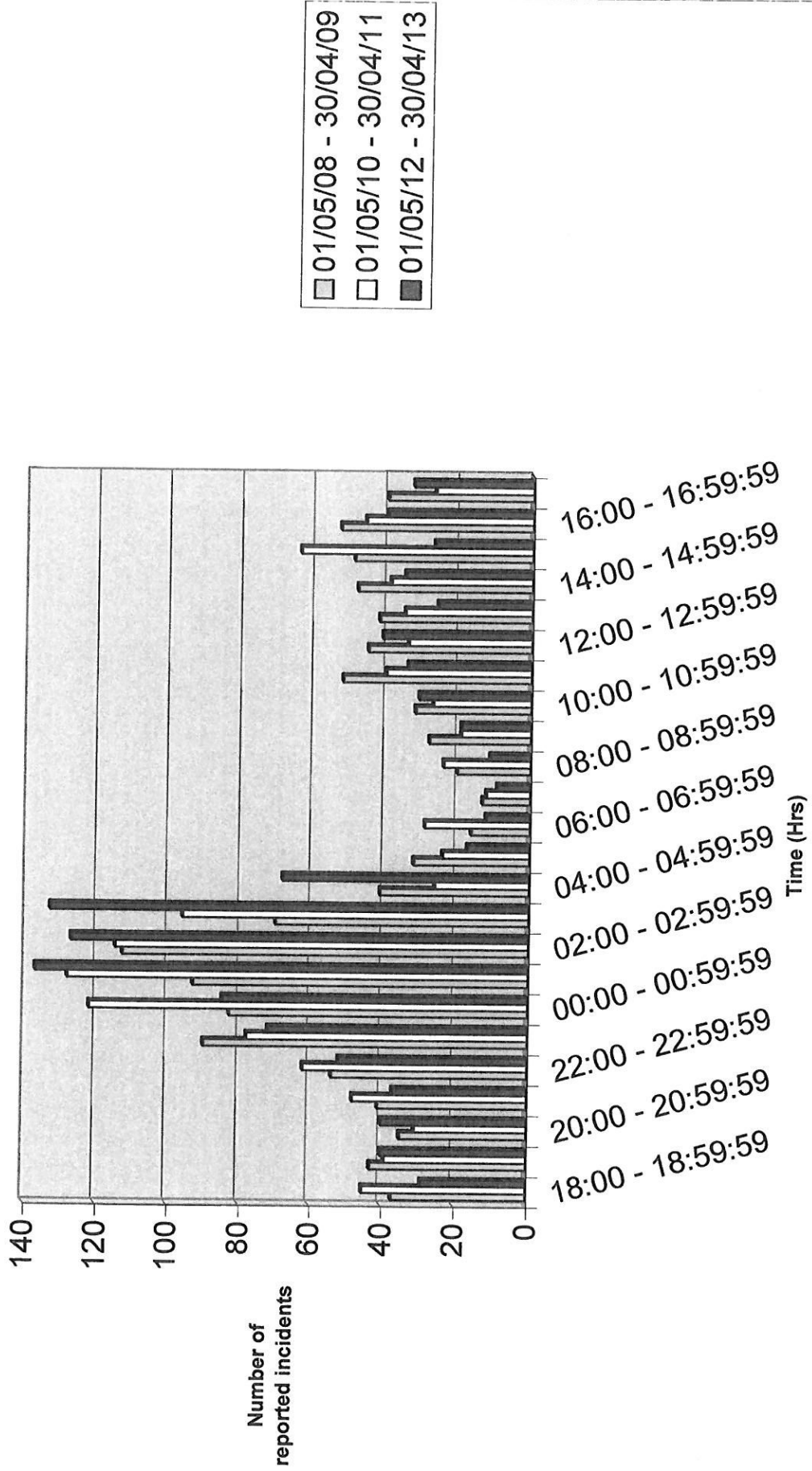

01/03/13 - 10/09/13

Occ #	Dom	Type	Time	Score	Notes
1	44130330794	Hamp	Criminal damage	01/09/2013 02:06	Filed - JUNK NIGHTCLUB, 55 LONDON ROAD SOUTHAMPTON, HAMPSHIRE United Kingdom SO15 2AD (JUNK) (OCU: 1 WESTERN, District: S SOUTHAMPTON, Sector: SW CENTRAL SOUTHAMPTON WEST, Beat: 1SW03 POLYGON) Male in smoking area of Junk, Throws a shoe which lands on the bonnett of a parked vehicle causing damage.
2	44130327787	Hamp	Assault	30/08/2013 01:14	Under investigation - 0 WINCHESTER STREET SOUTHAMPTON, HAMPSHIRE United Kingdom (OCU: 1 WESTERN, District: S SOUTHAMPTON, Sector: SW CENTRAL SOUTHAMPTON WEST, Beat: 1SW03 POLYGON) Report of a male assaulted by being hit on the head near to Junk. Suspect and girlfriend came from Junk.
3	44130320882	Hamp	Assault	25/08/2013 00:56	Filed - JUNK NIGHTCLUB, 55 LONDON ROAD SOUTHAMPTON, HAMPSHIRE United Kingdom SO15 2AD (JUNK) (OCU: 1 WESTERN, District: S SOUTHAMPTON, Sector: SW CENTRAL SOUTHAMPTON WEST, Beat: 1SW03 POLYGON) Suspect ejected from JUNK for being drunk and abusive. Continued to be abusive towards door staff and police.
4	44130309841	Hamp	Public order	17/08/2013 03:06	Filed - JUNK NIGHTCLUB, 55 LONDON ROAD SOUTHAMPTON, HAMPSHIRE United Kingdom SO15 2AD (JUNK) (OCU: 1 WESTERN, District: S SOUTHAMPTON, Sector: SW CENTRAL SOUTHAMPTON WEST, Beat: 1SW03 POLYGON) Racially Aggravated Section 5 Public Order - male approached officers using foul language, which continued despite repeated warnings. Comments made regarding the nationality of taxi drivers. Offender had just come from Junk.
5	44130308300	Hamp	Assault	16/08/2013 03:43	Under investigation - JUNK NIGHTCLUB, 55 LONDON ROAD SOUTHAMPTON, HAMPSHIRE United Kingdom SO15 2AD (JUNK) (OCU: 1 WESTERN, District: S SOUTHAMPTON, Sector: SW CENTRAL SOUTHAMPTON WEST, Beat: 1SW03 POLYGON) MALES FIGHTING WITHIN JUNK NIGHTCLUB THIS HAS THEN CONTINUED OUTSIDE AND DOORSTAFF ASSAULTED.
6	44130304227	Hamp	Public order	13/08/2013 13:09	Filed - JUNK NIGHTCLUB, 55 LONDON ROAD SOUTHAMPTON, HAMPSHIRE United Kingdom SO15 2AD (JUNK) (OCU: 1 WESTERN, District: S SOUTHAMPTON, Sector: SW CENTRAL SOUTHAMPTON WEST, Beat: 1SW03 POLYGON) Suspect was racially abusive, in the course of a series of events detailed in linked occurrences. Abuse was targeted at two Polish Door Staff at the Junk nightclub.
7	44130290055	Hamp	Assault	04/08/2013 02:01	Filed - JUNK NIGHTCLUB, 55 LONDON ROAD SOUTHAMPTON, HAMPSHIRE United Kingdom SO15 2AD (JUNK) (OCU: 1 WESTERN, District: S SOUTHAMPTON, Sector: SW CENTRAL SOUTHAMPTON WEST, Beat: 1SW03 POLYGON) JVS - FIGHT /// SD92 - PARTIES SEPERATE NO ISSUES /// IC1 GREY T SHIRT AND MAUVE BOTTOMS. / SHORT HAIR / SCULPTED FACIAL HAIR - LONG SIDIES /// IC1 TALL MEDIUM TO LARGE / BLOND HAIR / WHITE SHIRT AND BLUE JEANS. / *** RESULT *** // ALL PARTIES SEPERATED NO COMPLAINTS
8	44130264851	Hamp	Assault	17/07/2013 23:33	Under investigation - PNC wanted - JUNK NIGHTCLUB, 55 LONDON ROAD SOUTHAMPTON, HAMPSHIRE United Kingdom SO15 2AD (JUNK) (OCU: 1 WESTERN, District: S SOUTHAMPTON, Sector: SW CENTRAL SOUTHAMPTON WEST, Beat: 1SW03 POLYGON) Assault on 3 x Door staff at JUNK Nightclub.
9	44130263542	Hamp	Assault	17/07/2013 02:44	Filed - JUNK NIGHTCLUB, 55 LONDON ROAD SOUTHAMPTON, HAMPSHIRE United Kingdom SO15 2AD (JUNK) (OCU: 1 WESTERN, District: S SOUTHAMPTON, Sector: SW CENTRAL SOUTHAMPTON WEST, Beat: 1SW03 POLYGON) Suspect tried to bite the hand of a door supervisor whilst being restrained. Suspect also threatened door staff to the point that he was restrained again after the first episode and police were then called.
10	44130257829	Hamp	Drug offences	13/07/2013 02:29	Filed - JUNK NIGHTCLUB, 55 LONDON ROAD SOUTHAMPTON, HAMPSHIRE United Kingdom SO15 2AD (JUNK) (OCU: 1 WESTERN, District: S SOUTHAMPTON, Sector: SW CENTRAL SOUTHAMPTON WEST, Beat: 1SW03 POLYGON) FOUND IN POSSESSION OF A SMALL QUANTITY OF MDMA FOR PERSONAL USE
11	44130247318	Hamp	Wounding	06/07/2013 01:06	Under investigation - JUNK NIGHTCLUB, 55 LONDON ROAD SOUTHAMPTON, HAMPSHIRE United Kingdom SO15 2AD (JUNK) (OCU: 1 WESTERN, District: S SOUTHAMPTON, Sector: SW CENTRAL SOUTHAMPTON WEST, Beat: 1SW03 POLYGON) FOLLOWING AN ALTERATION BETWEEN AND HAS RECEIVED A 4CM DEEP BITE WOUND TO HIS LOWER LIP AND FACE. HE HAS REQUIRED SURGERY FOR THIS WOUND WHICH WILL PERMANENTLY SCAR.
12	44130232837	Hamp	Assault	26/06/2013 03:13	Filed - JUNK NIGHTCLUB, 55 LONDON ROAD SOUTHAMPTON, HAMPSHIRE United Kingdom SO15 2AD (JUNK) (OCU: 1 WESTERN, District: S SOUTHAMPTON, Sector: SW CENTRAL SOUTHAMPTON WEST, Beat: 1SW03 POLYGON) ONE DETAINED FOR ASSAULT / SD53 RESUMING FROM #1356 SHORTLY / SD91 - JUNK AWARE, WILL DETAIN UNTIL POLICE CAN ARRIVE / SD53 - MALE HAS A CUT AND LUMP TO HIS HEAD - REQUEST AMBULANCE PLEASE BEFORE CUSTODY / C1 - AMB REF: 152 / SD53 - NO COMPLAINT FROM AGGD // SRCH ::: / AS:1 DNA:1 DH:1 LX:1 RECORD 1 / HAMLETT, WAYNE PAUL PNCID 04/500244D / 21/09/86 CRO 395068/04X / MALE WHITENORTHEURO // DNA CONFIRMED // LAST KNOWN ADDRESS AS AT 22/09/04 (HOME) / 1 (41C4) // SD53 - NO COMPLAINT - GIVEN S27. / *** RESULT *** / NO CO
13	44130232765	Hamp	Assault	26/06/2013 00:39	Filed - JUNK NIGHTCLUB, 55 LONDON ROAD SOUTHAMPTON, HAMPSHIRE United Kingdom SO15 2AD (JUNK) (OCU: 1 WESTERN, District: S SOUTHAMPTON, Sector: SW CENTRAL SOUTHAMPTON WEST, Beat: 1SW03 POLYGON) VS-CALL FROM JUNK. AT REAR, SMALL FIGHT OCCURRING / VS- NO FIGHT SEEN / VS- NOT SEEN FIGHT, / SD50 CAMER A ACTICATION MAWBRAY WAY / SD50- MALE REMOVED FROM CITY, NO COMPLAINTS / *** RESULT *** / AS PER UPDATE

14	44130218782	Hamp	Drug offences	16/06/2013 00:42	Filed - JUNK NIGHTCLUB, 55 LONDON ROAD SOUTHAMPTON, HAMPSHIRE United Kingdom SO15 2AD (JUNK) (OCU: 1 WESTERN, District: S SOUTHAMPTON, Sector: SW CENTRAL SOUTHAMPTON WEST, Beat: 1SW03 POLYGON) Male stopped by staff in JUNK and handed over suspected drugs
15	44130193542	Hamp	Assault	29/05/2013 03:29	Filed - JUNK NIGHTCLUB, 55 LONDON ROAD SOUTHAMPTON, HAMPSHIRE United Kingdom SO15 2AD (JUNK) (OCU: 1 WESTERN, District: S SOUTHAMPTON, Sector: SW CENTRAL SOUTHAMPTON WEST, Beat: 1SW03 POLYGON) male has punched the manager of JUNK in the face after he was stopped from attempting to steal a bottle of vodka and rum
16	44130179050	Hamp	Drug offences	18/05/2013 01:51	Filed - JUNK NIGHTCLUB, 55 LONDON ROAD SOUTHAMPTON, HAMPSHIRE United Kingdom SO15 2AD (JUNK) (OCU: 1 WESTERN, District: S SOUTHAMPTON, Sector: SW CENTRAL SOUTHAMPTON WEST, Beat: 1SW03 POLYGON) This is a spontaneous arrest as a result of request to assist doorstaff at JUNK Nightclub on London Road. The doorstaff reported that they had spotted the male using white powder in the toilets and that this male had handed them a wrap made from folded paper saying that it contained cocaine. The staff then escorted him to the front of the property where police attended. I have been given the circumstances by the arresting officer, Pc 25674, who says that the d/p made a significant statement admitting that the powder was cocaine. S.32 search conducted and a further two wraps located in his trouser pocket that d/p said were ketamine. Strip search conducted and nil else found./
17	44130171198	Hamp	Drug offences	12/05/2013 04:03	Filed - JUNK NIGHTCLUB, 55 LONDON ROAD SOUTHAMPTON, HAMPSHIRE United Kingdom SO15 2AD (JUNK) (OCU: 1 WESTERN, District: S SOUTHAMPTON, Sector: SW CENTRAL SOUTHAMPTON WEST, Beat: 1SW03 POLYGON) Male reported for possession of controlled drug after being found at JUNK with white powder, now identified as Cocaine
18	44130156061	Hamp	Assault	01/05/2013 02:08	Filed - JUNK NIGHTCLUB, 55 LONDON ROAD SOUTHAMPTON, HAMPSHIRE United Kingdom SO15 2AD (JUNK) (OCU: 1 WESTERN, District: S SOUTHAMPTON, Sector: SW CENTRAL SOUTHAMPTON WEST, Beat: 1SW03 POLYGON) During an altercation in Junk one male was assaulted causing ABH injuries. No complaints in relation to the assault, please file.
19	44130151980	Hamp	Public order	27/04/2013 23:11	Filed - JUNK NIGHTCLUB, 55 LONDON ROAD SOUTHAMPTON, HAMPSHIRE United Kingdom SO15 2AD (JUNK) (OCU: 1 WESTERN, District: S SOUTHAMPTON, Sector: SW CENTRAL SOUTHAMPTON WEST, Beat: 1SW03 POLYGON) Male verbally arguing with others in the queue for Junk Nightclub. Male detained by doorstaff
20	44130142395	Hamp	Drug offences	21/04/2013 00:51	Filed - JUNK NIGHTCLUB, 55 LONDON ROAD SOUTHAMPTON, HAMPSHIRE United Kingdom SO15 2AD (JUNK) (OCU: 1 WESTERN, District: S SOUTHAMPTON, Sector: SW CENTRAL SOUTHAMPTON WEST, Beat: 1SW03 POLYGON) OFFICERS WERE CALLED TO "JUNK" NIGHTCLUB. DOORSTAFF REPORTING SEARCHED A MALE PRIOR TO ENTRY TO THE CLUB. SMALL CLEAR PLASTIC BAG CONTAINING WHITE POWDER AND A WRAP WERE LOCATED IN HIS RIGHT JEAN POCKET MALE DETAINED POSSESSION OF CONTROLLED SUBSTANCE. ONCE IN CUSTODY MALE VOLUNTEERED HAD MORE WRAPS HIDDEN IN HIS UNDERWEAR. STRIP SEARCH CARRIED OUT WHERE A LARGE QUANTITY OF WRAPS LOCATED WITHIN A SOCK IN HIS BOXER SHORTS. FURTHER DETAINED FOR POSSESSION WITH INTENT TO SUPPLY.
21	44130139491	Hamp	Drug offences	19/04/2013 00:58	Filed - JUNK NIGHTCLUB, 55 LONDON ROAD SOUTHAMPTON, HAMPSHIRE United Kingdom SO15 2AD (JUNK) (OCU: 1 WESTERN, District: S SOUTHAMPTON, Sector: SW CENTRAL SOUTHAMPTON WEST, Beat: 1SW03 POLYGON) STOPPED WITH A SMALL QUANTITY OF WHITE POWDER THAT HE HAD PURCHASED FROM WITHIN JUNK NIGHTCLUB. CONFIRMED AS COCAINE
22	44130127841	Hamp	Assault	10/04/2013 02:40	Filed - JUNK NIGHTCLUB, 55 LONDON ROAD SOUTHAMPTON, HAMPSHIRE United Kingdom SO15 2AD (JUNK) (OCU: 1 WESTERN, District: S SOUTHAMPTON, Sector: SW CENTRAL SOUTHAMPTON WEST, Beat: 1SW03 POLYGON) VS - MALE HAS BEEN FILMING STAFF AND THEY HAVE TAKEN HIS PHONE OFF HIM // SD05E - JUNK NEEDED TO BE ADVISED TO RETURN THE PHONE TO THE OWNER THEY HAVE NO GROUNDS TO KEEP IT. // VS - THEY HAVE GIVEN THE PHONE BACK - THEY WOULD LIKE SOMEONE THERE TO ISSUE THE MALE WITH A SEC 27 // SD50 #0062 / SD53 #0061 / SD71 ST9 / SD93 TRANSPORT // VS THE MALE HAS MOVED AWAY FROM JUNK - POLICE NO LONGER REQUIRED / *** RESULT *** // MALE LEFT PRIOR TO DEPLOYMENT - POLICE STOOD DOWN
23	44130125033	Hamp	Drug offences	06/04/2013 01:51	Filed - JUNK NIGHTCLUB, 55 LONDON ROAD SOUTHAMPTON, HAMPSHIRE United Kingdom SO15 2AD (JUNK) (OCU: 1 WESTERN, District: S SOUTHAMPTON, Sector: SW CENTRAL SOUTHAMPTON WEST, Beat: 1SW03 POLYGON) Male was overheard in toilet talking about drugs, searched by doorstaff and 4 x wraps of powder found. DP states they are MDMA.
24	44130102287	Hamp	Assault	20/03/2013 03:32	Filed - JUNK NIGHTCLUB, 55 LONDON ROAD SOUTHAMPTON, HAMPSHIRE United Kingdom SO15 2AD (JUNK) (OCU: 1 WESTERN, District: S SOUTHAMPTON, Sector: SW CENTRAL SOUTHAMPTON WEST, Beat: 1SW03 POLYGON) Aggrieved was stood on the dancefloor in Junk when another unknown male punched him in the face.

44130098672	Hamp	Drug offences	17/03/2013 04:37	Under investigation - PNC wanted - JUNK NIGHTCLUB, 55 LONDON ROAD SOUTHAMPTON, HAMPSHIRE United Kingdom SO15 2AD (JUNK) (OCU: 1 WESTERN, District: S SOUTHAMPTON, Sector: SW CENTRAL SOUTHAMPTON WEST, Beat: 1SW03 POLYGON) On Sunday 17th March 2013 officers were called to the Junk Club on London Road, Southampton. The defendant had been found in a toilet cubicle by door staff in the company of two other males. They were all detained by door staff and were searched. A quantity of individually wrapped substances suspected to be controlled drugs were found in the possession of the suspect. Upon attending Police officers arrested the suspect and in a subsequent search a further quantity of drugs were recovered from his sock.
44130098578	Hamp	Drug offences	17/03/2013 02:17	Filed - JUNK NIGHTCLUB, 55 LONDON ROAD SOUTHAMPTON, HAMPSHIRE United Kingdom SO15 2AD (JUNK) (OCU: 1 WESTERN, District: S SOUTHAMPTON, Sector: SW CENTRAL SOUTHAMPTON WEST, Beat: 1SW03 POLYGON) Doorstaff at JUNK witnessed a male snorting powder from a key. Searched by doorstaff and found in possession of a quantity of Controlled substance.
44130083733	Hamp	Assault	06/03/2013 02:54	Filed - JUNK NIGHTCLUB, 55 LONDON ROAD SOUTHAMPTON, HAMPSHIRE United Kingdom SO15 2AD (JUNK) (OCU: 1 WESTERN, District: S SOUTHAMPTON, Sector: SW CENTRAL SOUTHAMPTON WEST, Beat: 1SW03 POLYGON) Report of male fighting outside Junk. Door staff had detained a male who was highly agitated. He continued to shout abuse at every one present and was arrested public order offence. A female then identified her self as being assaulted by the male. He had pushed her to the floor causing an injury to her knee.
44130084374	Hamp	Public order	06/03/2013 02:54	Filed - JUNK NIGHTCLUB, 55 LONDON ROAD SOUTHAMPTON, HAMPSHIRE United Kingdom SO15 2AD (JUNK) (OCU: 1 WESTERN, District: S SOUTHAMPTON, Sector: SW CENTRAL SOUTHAMPTON WEST, Beat: 1SW03 POLYGON) Report of male fighting outside Junk. Door staff had detained a male who was highly agitated. He continued to shout abuse at every one present and was arrested public order offence. A female then identified her self as being assaulted by the male. He had pushed her to the floor causing an injury to her knee.
44130061737	Hamp	Public order	17/02/2013 03:29	District: S SOUTHAMPTON, Sector: SW CENTRAL SOUTHAMPTON WEST, Beat: 1SW03 POLYGON VS - YOUTHS FIGHTING SMOKING AREA / XS1A- MALE LEFT TO GO HOME AIO HERE NOW / *** RESULT ** / AS UPDATE Filed - JUNK NIGHTCLUB, 55 LONDON ROAD SOUTHAMPTON, HAMPSHIRE United Kingdom SO15 2AD (JUNK) (OCU: 1 WESTERN, District: S SOUTHAMPTON, Sector: SW CENTRAL SOUTHAMPTON WEST, Beat: 1SW03 POLYGON) VS - FIGHT OUTSIDE JUNK / VS - LOOKS LIKE DOOR STAFF TRYING TO RESTRAIN / VS - SEEMS TO BE CALMING DOWN NOW PARTIES DISPERSING / ARV25 - IT HAS CALMED DOWN / ARV25 - JUST GETTING TO THE BOTTOM OF THIS, OTHER UNITS CAN STAND DOWN EVERYONE ELSE HAS GONE / ARV25 - SOME SORT OF ALTERCATION HAS OCCURRED HERE BUT EVERYONE HAS SCARPERED WHEN THEY REALISED WE WOULD BE TURNING UP - NO COMPLAINTS / *** RESULT ** / NO COMPLAINTS, ALL PARTIES HAD LEFT ON POLICE ARRIVAL. NO OFFENCES CONFIRMED.
44130043279	Hamp	Public order	03/02/2013 04:26	Filed - JUNK NIGHTCLUB, 55 LONDON ROAD SOUTHAMPTON, HAMPSHIRE United Kingdom SO15 2AD (JUNK) (OCU: 1 WESTERN, District: S SOUTHAMPTON, Sector: SW CENTRAL SOUTHAMPTON WEST, Beat: 1SW03 POLYGON) VS - 3 PROBLEM MALES OUTSIDE // VS - DISREGARD - SOMEONE HAS COME TO PICK THEM UP AND THEY ARE LEAVING / *** RESULT ** // MALES LEFT PRIOR TO POLICE ARRIVAL
44130028295	Hamp	Public order	23/01/2013 03:00	Filed - JUNK NIGHTCLUB, 55 LONDON ROAD SOUTHAMPTON, HAMPSHIRE United Kingdom SO15 2AD (JUNK) (OCU: 1 WESTERN, District: S SOUTHAMPTON, Sector: SW CENTRAL SOUTHAMPTON WEST, Beat: 1SW03 POLYGON) Junk called [REDACTED] acting in a strange manner outside Junk nightclub, LONDON ROAD, Southampton. LEIGH rolling around in the snow on the ground and trying to jump the barrier. Junk requested police assistance to move on [REDACTED]. Police arrived and have spoken to [REDACTED] incoherent and intoxicated. Unsteady on his feet and speaking with slurred speech. Unable to understand LEIGH when speaking to Police. Upon asking LEIGH for identification [REDACTED] has pulled out a small plastic bag of white powder. [REDACTED] has been arrested and cautioned for suspicion of being in possession a class a controlled substance
44130024771	Hamp	Drug offences	20/01/2013 02:03	

25

26

27

28

29

30

31

32

Working Sheet

Hampshire Constabulary

Printed: 29/08/2013 10:09 by 24288

Occurrence: **44130076993 ASB Nui - Misc ASB @01/03/2013 03:22**

Author:	#18 PLASCOTT, C.	Report time:	01/03/2013 23:47
Entered by:	#18 PLASCOTT, C.	Entered time:	01/03/2013 23:47
Remarks:	Licensing review		

01/03/13 - I have attended Junk this evening with Pc Conway in response to this incident and 44130076952 which happened in the early hours of this morning. We spoke with door staff and with the Bar Manager, both stated that the males involved in this incident were actually the main act performing at the venue. Their details will be available. The head Doorman, Chris stated that as he walked into the gents toilets within the venue he noticed that one of this group was snorting a line of cocaine from off of his forearm. Chris challenged this male who became abusive and tried to continue taking the drug. Chris started to eject this male and when doing so the rest of the male's friends, approx 10, all began to get abusive, one or two began throwing glasses and a chair. The doorstaff were outnumbered at one stage and called WWUN. Police attended and the group were dispersed.

I have challenged the door staff as to why they have not provided statements and more details as the males in this group should be at the very least provided with a red card ban if we are unable to prove any substantive offences.

However they state that they do have CCTV and there are staff who witnessed this incident, Chris the doorman will provide a statement.

I have tasked the original officer who attended to re-attend take statements and cctv footage to progress this.

PS 18

This page is intentionally left blank

Agenda Item 8



Reference: 2013/02150/01SPRV

Hearing: 7th November 2013

APPLICATION TO VARY A PREMISES LICENCE

Premises Name: Genting Club Terminus Terrace Application Date: 10th September 2013

Premises Address: Terminus House
Terminus Terrace
Southampton
SO14 3FE Application Received Date: 12th September 2013

Application Valid Date: 12th September 2013

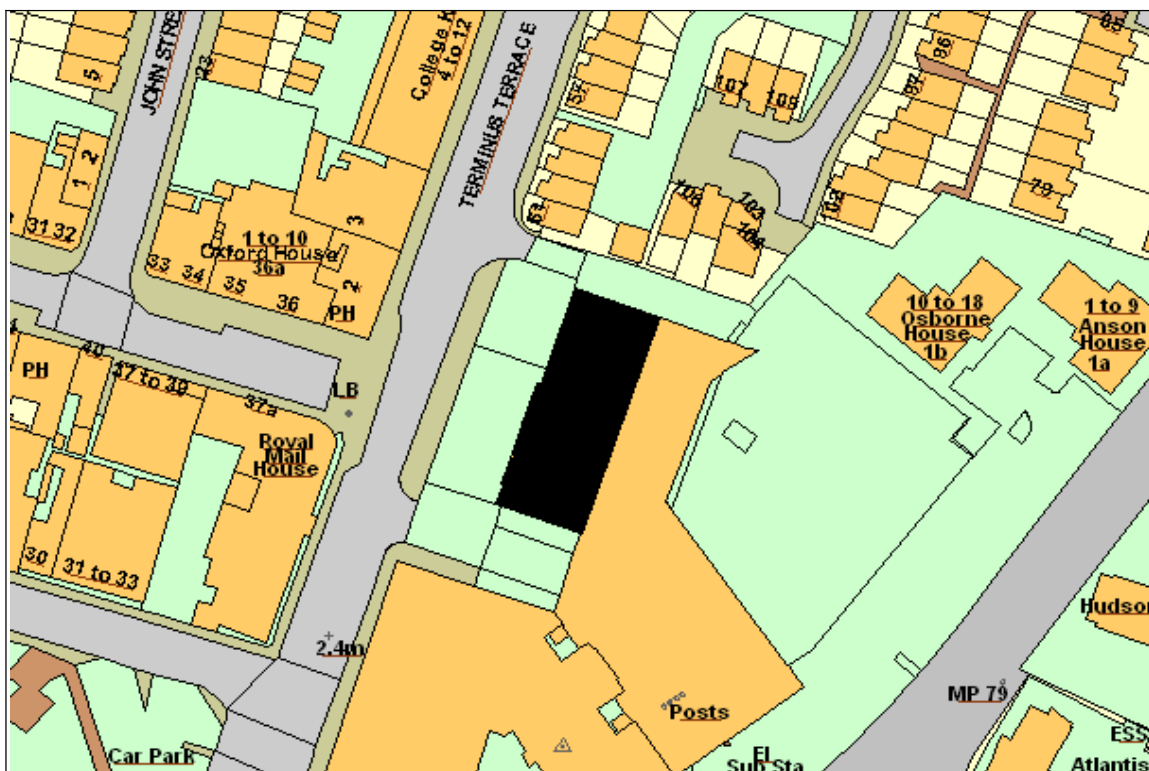

This map is reproduced from Ordnance Survey material with the permission of Ordnance Survey on behalf of the Controller of Her Majesty's Stationery Office © Crown copyright. Unauthorised reproduction infringes Crown copyright and may lead to prosecution or civil proceedings. Southampton City Council Licence No. 100019679 2007.

Representations From Responsible Authorities

Responsible Authority	Satisfactory?	Comments
Child Protection Services - Licensing	Yes	

Hampshire Fire And Rescue - Licensing	Yes	
Environmental Health - Licensing	Yes	
Planning & Sustainability - Building Control - Licensing	Yes	
Primary Care Trust - Public Health Manager	No Response Received	
Planning & Sustainability - Development Control - Licensing	Yes	
Police - Licensing	No	
Trading Standards - Licensing	Yes	

Other Representations

Name	Address	Contributor Type
Ms. Sonja Angus	108 Imperial Apartments South Western House Southampton SO14 3AL	Resident
Mr. David Riley	2 Terminus Terrace Southampton SO14 3DT	Resident

Legal Implications

1. The Licensing Act 2003 specifically restricts the grounds on which the Council, as Licensing Authority (LA), may refuse an application for a major variation of a Premises Licence, or impose conditions. Where relevant representations are made, the LA may refuse on the grounds that the licensing objectives are not met or the operating schedule is inadequate. Equally, conditions may be imposed where relevant and necessary. The LA may also refuse an application in part and thereby only permit some of the licensable activities sought.
2. The decision making committee, in considering an application, must have regard to the adopted Statement of Licensing Policy and any relevant representations made by those directly affected.
3. An applicant for a variation, whose application has been refused, or who is aggrieved by conditions imposed, may appeal against the decision to the Magistrates' Court.
4. In considering this application the committee will sit in a quasi-judicial capacity and is thus obliged to consider applications in accordance with both the Licensing Act 2003 (Hearings) Regulations 2005, and amending secondary legislation and the rules of natural justice. The practical effect of this is that the committee must make its decision based on evidence submitted in accordance with the legislation and give adequate reasons for reaching its decision.

The committee must also have regard to:-

5. *Crime and Disorder Act 1998*
Section 17 of the Crime and Disorder Act 1998 places the Council under a duty to exercise its various functions with due regard to the likely effect of the exercise of those functions on, and the need to do all that it reasonably can to prevent, crime and disorder in its area.
6. *Human Rights Act 1998*
The Act requires UK legislation to be interpreted in a manner consistent with the European Convention on Human Rights. It is unlawful for the Council to act in a way that is incompatible (or fail to act in a way that is compatible) with the rights protected by the Act. Any action undertaken by the Council that could have an effect upon another person's Human Rights must be taken having regard to the principle of Proportionality - the need to balance the rights of the individual with the rights of the community as a whole. Any action taken by the Council which affects another's rights must be no more onerous than is necessary in a democratic society. The matter set out in this report must be considered in light of the above obligations.

Application to vary a premises licence under the Licensing Act 2003

PLEASE READ THE FOLLOWING INSTRUCTIONS FIRST

Before completing this form please read the guidance notes at the end of the form.
 If you are completing this form by hand please write legibly in block capitals. In all cases ensure that your answers are inside the boxes and written in black ink. Use additional sheets if necessary.

You may wish to keep a copy of the completed form for your records.

I/We Genting Casinos UK Limited

(Insert name(s) of applicant)

being the premises licence holder, apply to vary a premises licence under section 34 of the Licensing Act 2003 for the premises described in Part 1 below

Premises licence number 2012/00566/01 SPRD
--

Part 1 – Premises Details

Postal address of premises or, if none, ordnance survey map reference or description Genting Club Terminus Terrace Terminus House Terminus Terrace			
Post town	Southampton	Post code	SO14 3FE

Telephone number at premises (if any)	023 8022 1021
Non-domestic rateable value of premises	£125000+

Part 2 – Applicant details

Daytime contact telephone number	0121 325 7780		
E-mail address (optional)			
Current postal address if different from premises address	Genting Casinos UK Limited Genting Club Star City Watson Road		
Post Town	Birmingham	Postcode	B7 5SA



Part 3 - Variation

Do you want the proposed variation to have effect as soon as possible?

Please tick yes

If not do you want the variation to take effect from

Day Month Year

--	--	--	--	--	--	--	--	--	--

Please describe briefly the nature of the proposed variation (Please see guidance note 1)
In summary the application is to vary the Premises Licence and Premises Licence Plans to extend the area licensed for the sale of alcohol and late night refreshment into the external area at the front of the premises as more particularly shown on the proposed amended Premises Licence Plan that accompanies this application and accordingly the application also requests the removal of existing condition stating "all activities permitted by this Licence shall take place inside the Licensed Premises".

If your proposed variation would mean that 5,000 or more people are expected to attend the premises at any one time, please state the number expected to attend

0 N/A

Part 4 Operating Schedule

Please complete those parts of the Operating Schedule below which would be subject to change if this application to vary is successful.

Provision of regulated entertainment

Please tick yes

- a) plays (if ticking yes, fill in box A)
- b) films (if ticking yes, fill in box B)
- c) indoor sporting events (if ticking yes, fill in box C)
- d) boxing or wrestling entertainment (if ticking yes, fill in box D)
- e) live music (if ticking yes, fill in box E)
- f) recorded music (if ticking yes, fill in box F)
- g) performances of dance (if ticking yes, fill in box G)
- h) anything of a similar description to that falling within (e), (f) or (g) (if ticking yes, fill in box H)

Provision of entertainment facilities:

- i) making music (if ticking yes, fill in box I)
- j) dancing (if ticking yes, fill in box J)
- k) entertainment of a similar description to that falling within (i) or (j) (if ticking yes, fill in box K)

Provision of late night refreshment (if ticking yes, fill in box L)

Sale by retail of alcohol (if ticking yes, fill in box M)

In all cases complete boxes N, O and P

A

Plays Standard days and timings (please read guidance note 6)			Will the performance of a play take place indoors or outdoors or both – please tick (please read guidance note 2)	Indoors	<input type="checkbox"/>
				Outdoors	<input type="checkbox"/>
				Both	<input type="checkbox"/>
Day	Start	Finish	Please give further details here (please read guidance note 3)		
Mon					
Tue			State any seasonal variations for performing plays (please read guidance note 4)		
Wed					
Thur			Non standard timings. Where you intend to use the premises for the performance of plays at different times to those listed in the column on the left, please list (please read guidance note 5)		
Fri					
Sat					
Sun					

B

Films Standard days and timings (please read guidance note 6)			<u>Will the exhibition of films take place indoors or outdoors or both – please tick</u> (please read guidance note 2)		Indoors <input type="checkbox"/>
					Outdoors <input type="checkbox"/>
					Both <input type="checkbox"/>
Day	Start	Finish	<u>Please give further details here</u> (please read guidance note 3)		
Mon					
Tue					
Wed			<u>State any seasonal variations for the exhibition of films</u> (please read guidance note 4)		
Thur					
Fri			<u>Non standard timings. Where you intend to use the premises for the exhibition of films at different times to those listed in the column on the left, please list</u> (please read guidance note 5)		
Sat					
Sun					

C

Indoor sporting events Standard days and timings (please read guidance note 6)			<u>Please give further details</u> (please read guidance note 3)
Day	Start	Finish	
Mon			
Tue			<u>State any seasonal variations for indoor sporting events</u> (please read guidance note 4)
Wed			<u>Non standard timings. Where you intend to use the premises for indoor sporting events at different times to those listed in the column on the left, please list</u> (please read guidance note 5)
Thur			
Fri			
Sat			
Sun			

D

Boxing or wrestling entertainments Standard days and timings (please read guidance note 6)			Will the boxing or wrestling entertainment take place indoors or outdoors or both – please tick (please read guidance note 2)	Indoors	<input type="checkbox"/>
				Outdoors	<input type="checkbox"/>
				Both	<input type="checkbox"/>
Day	Start	Finish	Please give further details here (please read guidance note 3)		
Mon					
Tue			State any seasonal variations for boxing or wrestling entertainment (please read guidance note 4)		
Wed					
Thur			Non standard timings. Where you intend to use the premises for boxing or wrestling entertainment at different times to those listed in the column on the left, please list (please read guidance note 5)		
Fri					
Sat					
Sun					

E

Live music Standard days and timings (please read guidance note 6)			<u>Will the performance of live music take place indoors or outdoors or both – please tick</u> (please read guidance note 2)	Indoors	<input type="checkbox"/>
				Outdoors	<input type="checkbox"/>
				Both	<input type="checkbox"/>
Day	Start	Finish	<u>Please give further details here</u> (please read guidance note 3)		
Mon					
Tue					
Wed					
Thur					
Fri					
Sat					
Sun					
			<u>State any seasonal variations for the performance of live music</u> (please read guidance note 4)		
			<u>Non standard timings. Where you intend to use the premises for the performance of live music at different times to those listed in the column on the left, please list</u> (please read guidance note 5)		

F

Recorded music Standard days and timings (please read guidance note 6)			<u>Will the playing of recorded music take place indoors or outdoors or both – please tick</u> (please read guidance note 2)	Indoors	<input type="checkbox"/>
				Outdoors	<input type="checkbox"/>
				Both	<input type="checkbox"/>
Day	Start	Finish	<u>Please give further details here</u> (please read guidance note 3) Provision of recorded music, through the premises internal sound system, provision of Juke box, karaoke etc		
Mon					
Tue					
Wed					
Thur					
Fri					
Sat					
Sun					
			<u>State any seasonal variations for the playing of recorded music</u> (please read guidance note 4)		
			<u>Non standard timings. Where you intend to use the premises for the playing of recorded music at different times to those listed in the column on the left, please list</u> (please read guidance note 5)		

G

Performances of dance Standard days and timings (please read guidance note 6)			Will the performance of dance take place indoors or outdoors or both – please tick (please read guidance note 2)	Indoors	<input type="checkbox"/>
				Outdoors	<input type="checkbox"/>
				Both	<input type="checkbox"/>
Day	Start	Finish	Please give further details here (please read guidance note 3)		
Mon					
Tue			State any seasonal variations for the performance of dance (please read guidance note 4)		
Wed					
Thur			Non standard timings. Where you intend to use the premises for the performance of dance at different times to those listed in the column on the left, please list (please read guidance note 5)		
Fri					
Sat					
Sun					

H

Anything of a similar description to that falling within (e), (f) or (g) Standard days and timings (please read guidance note 6)			<u>Please give a description of the type of entertainment you will be providing</u>		
Day	Start	Finish	<u>Will this entertainment take place indoors or outdoors or both – please tick</u> (please read guidance note 2)	Indoors	<input type="checkbox"/>
Mon				Outdoors	<input type="checkbox"/>
				Both	<input type="checkbox"/>
Tue			<u>Please give further details here</u> (please read guidance note 3)		
Wed					
Thur			<u>State any seasonal variations for entertainment of a similar description to that falling within (e), (f) or (g)</u> (please read guidance note 4)		
Fri					
Sat			<u>Non standard timings. Where you intend to use the premises for the entertainment of a similar description to that falling within (e), (f) or (g) at different times to those listed in the column on the left, please list</u> (please read guidance note 5)		
Sun					

I

Provision of facilities for making music Standard days and timings (please read guidance note 6)			<u>Please give a description of the facilities for making music you will be providing</u>		
			<u>Will the facilities for making music be indoors or outdoors or both – please tick</u> (please read guidance note 2)		Indoors
			Outdoors	<input type="checkbox"/>	
			Both	<input type="checkbox"/>	
Day	Start	Finish	<u>Please give further details here</u> (please read guidance note 3)		
Mon					
Tue					
Wed					
Thur					
Fri					
Sat					
Sun					
			<u>State any seasonal variations for the provision of facilities for making music</u> (please read guidance note 4)		
			<u>Non standard timings. Where you intend to use the premises for provision of facilities for making music at different times to those listed in the column on the left, please list</u> (please read guidance note 5)		

J

Provision of facilities for dancing Standard days and timings (please read guidance note 6)			<u>Will the facilities for dancing be indoors or outdoors or both – please tick</u> (see guidance note 2)	Indoors <input type="checkbox"/>	
				Outdoors <input type="checkbox"/>	
				Both <input type="checkbox"/>	
Day	Start	Finish	<u>Please give a description of the facilities for dancing you will be providing</u>		
Mon			<u>Please give further details here</u> (please read guidance note 3)		
Tue					
Wed			<u>State any seasonal variations for providing dancing facilities</u> (please read guidance note 4)		
Thur					
Fri			<u>Non standard timings. Where you intend to use the premises for the provision of facilities for dancing at different times to those listed in the column on the left, please list</u> (please read guidance note 5)		
Sat					
Sun					

K

Provision of facilities for entertainment of a similar description to that falling within i or j Standard days and timings (please read guidance note 6)			<u>Please give a description of the type of entertainment facility you will be providing</u>		
Day	Start	Finish	<u>Will the entertainment facility be indoors or outdoors or both – please tick</u> (please read guidance note 2)	Indoors	<input type="checkbox"/>
Mon				Outdoors	<input type="checkbox"/>
				Both	<input type="checkbox"/>
Tue			<u>Please give further details here</u> (please read guidance note 3)		
Wed					
Thur			<u>State any seasonal variations for the provision of facilities for entertainment of a similar description to that falling within i or j</u> (please read guidance note 4)		
Fri					
Sat			<u>Non standard timings. Where you intend to use the premises for the provision of facilities for entertainment of a similar description to that falling within i or j at different times to those listed in the column on the left, please list</u> (please read guidance note 5)		
Sun					

L

Late night refreshment Standard days and timings (please read guidance note 6)			Will the provision of late night refreshment take place indoors or outdoors or both – please tick (please read guidance note 2)	Indoors	<input type="checkbox"/>
				Outdoors	<input type="checkbox"/>
				Both	<input type="checkbox"/>
Day	Start	Finish	Please give further details here (please read guidance note 3)		
Mon					
Tue			State any seasonal variations for the provision of late night refreshment (please read guidance note 4)		
Wed					
Thur			Non standard timings. Where you intend to use the premises for the provision of late night refreshment at different times, to those listed in the column on the left, please list (please read guidance note 5)		
Fri					
Sat					
Sun					

M

Supply of alcohol Standard days and timings (please read guidance note 6)			Will the supply of alcohol be for consumption (Please tick box) (please read guidance note 7)	On the premises	<input type="checkbox"/>
				Off the premises	<input type="checkbox"/>
				Both	<input type="checkbox"/>
Day	Start	Finish	State any seasonal variations for the supply of alcohol (please read guidance note 4)		
Mon					
Tue					
Wed					
Thur					
Fri					
Sat					
Sun					
			Non-standard timings. Where you intend to use the premises for the supply of alcohol at different times to those listed in the column on the left, please list (please read guidance note 5)		

N

Please highlight any adult entertainment or services, activities, other entertainment or matters ancillary to the use of the premises that may give rise to concern in respect of children (please read guidance note 8)

The premises operate as a Casino

O

Hours premises are open to the public Standard days and timings (please read guidance note 6)			<u>State any seasonal variations</u> (please read guidance note 4)
Day	Start	Finish	
Mon	00:00	00:00	<u>Non standard timings. Where you intend the premises to be open to the public at different times from those listed in the column on the left, please list</u> (please read guidance note 5)
Tue	00:00	00:00	
Wed	00:00	00:00	
Thur	00:00	00:00	
Fri	00:00	00:00	
Sat	00:00	00:00	
Sun	00:00	00:00	

Please identify those conditions currently imposed on the licence which you believe could be removed as a consequence of the proposed variation you are seeking
 The following condition shall be removed:-

"Annex 2

2. All activities permitted by this Licence shall take place inside the Licensed Premises"

Please tick yes

- I have enclosed the premises licence
- I have enclosed the relevant part of the premises licence

If you have not ticked one of these boxes please fill in reasons for not including the licence, or part of it, below

Reasons why I have failed to enclose the premises licence or relevant part of premises licence

P Describe any additional steps you intend to take to promote the four licensing objectives as a result of the proposed variation:

a) General – all four licensing objectives (b,c,d,e) (please read guidance note 9)

The premises are an established casino and save as set out below in respect of the external area there are no additional amendments proposed to the operating Schedule to this Licence.

b) The prevention of crime and disorder

N/A

c) Public safety

1. When the external area is in use for the provision of licensable activities, members of staff shall regularly monitor the external area to ensure that empty glasses, bottles and other drinking recepticals are cleared away promptly.

d) The prevention of public nuisance

1. The external area shown on the Premises Licence Plan shall only be licensed for the sale/supply of alcohol and provision of late night refreshment.

2. The provision of licensable activities in the external area shown on the Premises Licence Plan shall only be permitted between 08:00am and 02:00am.

3. When the external area shown on the Premises Licence Plan is in use for the provision of licensable activities after 22:00pm members of staff shall regularly monitor the area to ensure that no nuisance is caused to any nearby residential premises by customers using that area.

e) The protection of children from harm

N/A

Please tick yes

- I have made or enclosed payment of the fee
- I have sent copies of this application and the plan to responsible authorities and others where applicable
- I understand that I must now advertise my application
- I have enclosed the premises licence or relevant part of it or explanation
- I understand that if I do not comply with the above requirements my application will be rejected

IT IS AN OFFENCE, LIABLE ON CONVICTION TO A FINE UP TO LEVEL 5 ON THE STANDARD SCALE, UNDER SECTION 158 OF THE LICENSING ACT 2003 TO MAKE A FALSE STATEMENT IN OR IN CONNECTION WITH THIS APPLICATION

Part 5 – Signatures (please read guidance note 10)

Signature of applicant (the current premises licence holder) or applicant’s solicitor or other duly authorised agent (please read guidance note 11). **If signing on behalf of the applicant please state in what capacity.**

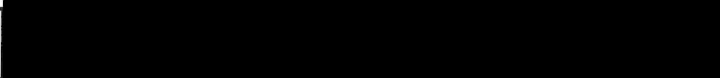
Signature	
Date	10/09/2013
Capacity	Duly Authorised Solicitor

Where the premises licence is jointly held signature of 2nd applicant (the current premises licence holder) or 2nd applicant’s solicitor or other authorised agent (please read guidance note 12). **If signing on behalf of the applicant please state in what capacity.**

Signature	
Date	
Capacity	

Contact name (where not previously given) and address for correspondence associated with this application (please read guidance note 13)

David N Roberts
Eversheds LLP
70 Great Bridgewater Street
#4620915

Post town	Manchester	Post code	M1 5ES
------------------	------------	------------------	--------

Telephone number (if any)	0845 497 8146
----------------------------------	---------------

If you would prefer us to correspond with you by e-mail your e-mail address (optional) davidnroberts@eversheds.com
--

Notes for Guidance

This application cannot be used to vary the licence so as to extend the period for which the licence has effect or to vary substantially the premises to which it relates. If you wish to make that type of change to the premises licence you should make a new premises licence application under section 17 of the Licensing Act 2003.

1. Describe the premises. For example the type of premises, its general situation and layout and any other information which could be relevant to the licensing objectives. Where your application includes off-supplies of alcohol and you intend to provide a place for consumption of these off-supplies you must include a description of where the place will be and its proximity to the premises.
2. Where taking place in a building or other structure please tick as appropriate. Indoors may include a tent.
3. For example state type of activity to be authorised, if not already stated, and give relevant further details, for example (but not exclusively) whether or not music will be amplified or unamplified.
4. For example (but not exclusively), where the activity will occur on additional days during the summer months.
5. For example (but not exclusively), where you wish the activity to go on longer on a particular day e.g. Christmas Eve.
6. Please give timings in 24 hour clock (e.g. 16:00) and only give details for the days of the week when you intend the premises to be used for the activity.
7. If you wish people to be able to consume alcohol on the premises please tick on, if you wish people to be able to purchase alcohol to consume away from the premises please tick off. If you wish people to be able to do both please tick both.
8. Please give information about anything intended to occur at the premises or ancillary to the use of the premises which may give rise to concern in respect of children regardless of whether you intend children to have access to the premises, for example (but not exclusively) nudity or semi-nudity, films for restricted age groups, the presence of gaming machines.
9. Please list here steps you will take to promote all four licensing objectives together.
10. The application form must be signed.
11. An applicant's agent (for example solicitor) may sign the form on their behalf provided that they have actual authority to do so.
12. Where there is more than one applicant, both applicants or their respective agents must sign the application form.
13. This is the address which we shall use to correspond with you about this application.

All dimensions to be checked on site prior to work commencing on site. Any discrepancies must be reported to MR+P immediately. This property has not been surveyed by MR+P. Any discrepancies must be reported to MR+P.

BLOCK PLAN - 1:500

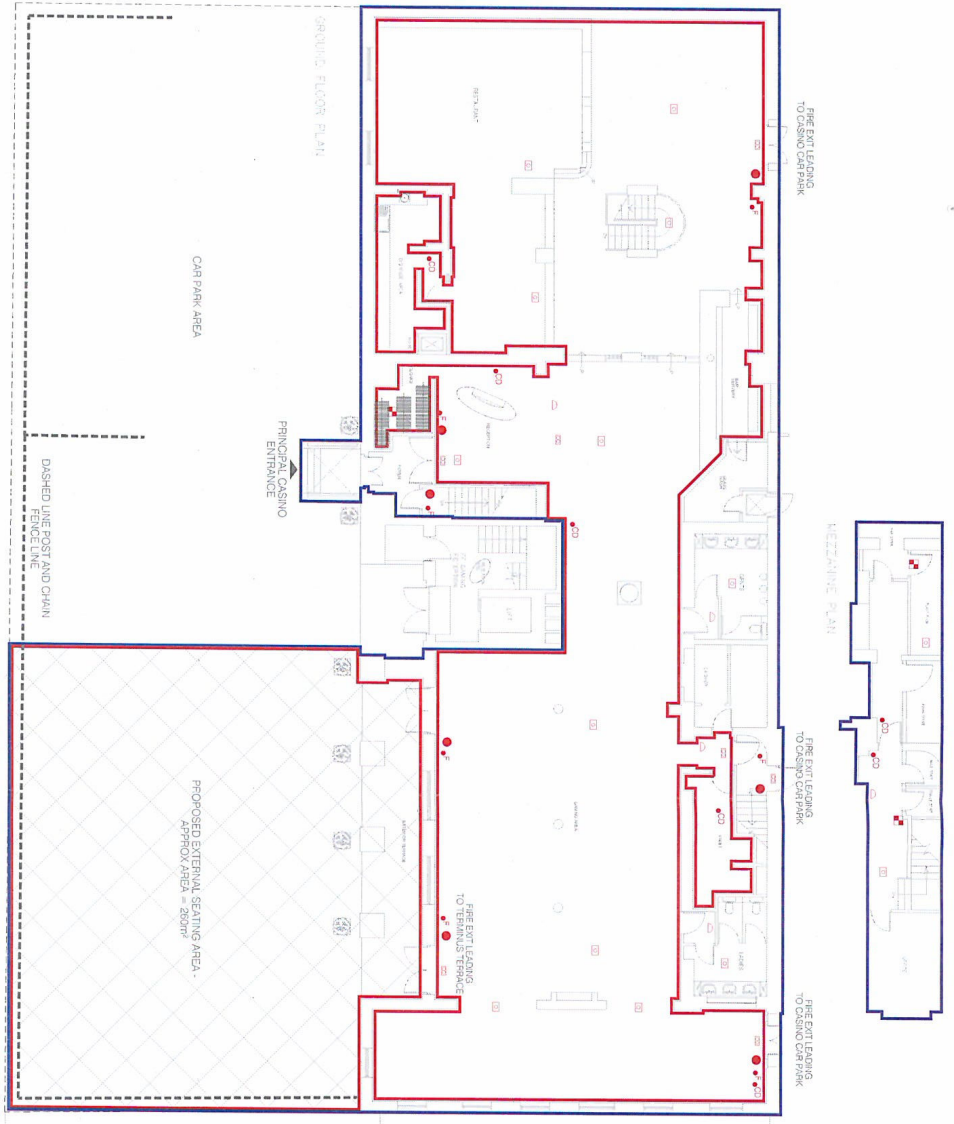
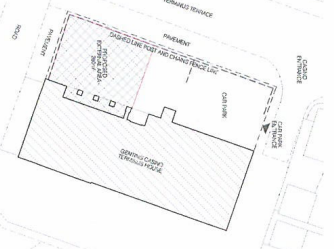

GROUND FLOOR PLAN - 1:100



BASEMENT PLAN



KEY

PROPERTY DEMISE

Extent of boundary / perimeter of the premises.

- Basement = 210m²
 - Ground Floor = 857m²
 - Mezzanine = 56.2m²
 - Total = 1123.2m²
- Sale and supply of alcohol
 - Provision of late night refreshment
 - Provision for regulated entertainment
 - Provision for entertainment facilities
- Basement = 0m²
 - Ground Floor = 463.2m²
 - Mezzanine Floor = 0m²
 - External Area = 260m²
 - Total = 723.2m²

- Break glass
- Heat detector unit
- Smoke detector unit
- Light & buzzer unit
- Sounder unit
- Water extinguisher
- Carbon Dioxide extinguisher
- Foam extinguisher
- Powder extinguisher
- Fire blanket
- Hose reel
- Illuminated exit sign

MR+P
ARCHITECTS

MELING RODGWAY + PARTNERS LTD
GARRET HOUSE MOORE STREET
GLASGOW G1 1JH
T: 0119 2723241
F: 0119 2723242
E: info@mr+p.co.uk
www.mr+p.co.uk

PROJECT
GENTING CLUB SOUTHAMPTON
TERMINUS HOUSE
TERMINUS TERRACE, SOUTHAMPTON
SO14 3FE

TITLE
BASEMENT, GROUND AND MEZZANINE PLANS

DRAWING STATUS
LICENCE DRAWING

DRAWN BY
DATE
AUGUST 2013

D.L.
SCALE
1:100@A1

DRAWING NO.
5154/601



HAMPSHIRE CONSTABULARY



**NEW GRANT OR VARIATION OF PREMISES LICENCE
OR CLUB PREMISES CERTIFICATE
FORM FOR REPRESENTATIONS FROM HAMPSHIRE CONSTABULARY**

Before completing this form please read the guidance notes on page 3.
Once completed please send your representation form to your local Licensing Authority.
You must keep a copy of the completed form for police records.

**Hampshire Constabulary wish to make a representation(s) regarding the grant or variation of a
Premises Licence or Club Premises Certificate issued under the Licensing Act 2003.
These representations must be made within 28 days**

Postal address of premises or club premises:

Genting Club
Terminus House
Terminus Terrace

Post town: Southampton

Postcode: SO14 3FE

Name of premises licence holder or club holding club premises certificate *(if known)*

Genting Casinos Uk Limited

Police Details

Hampshire Constabulary is a responsible authority.

Name and address:

PC 21071 NORRIS
Southampton Central Police Station
Southern Road
Southampton
SO15 1AN

This application to object relates to the following licensing objective(s)

- 1) The prevention of crime and disorder
- 2) Public safety
- 3) The prevention of public nuisance
- 4) The protection of children from harm

*Please select
one or more
boxes*





HAMPSHIRE CONSTABULARY

**NEW GRANT OR VARIATION OF PREMISES LICENCE
OR CLUB PREMISES CERTIFICATE
FORM FOR REPRESENTATIONS FROM HAMPSHIRE CONSTABULARY**

State the ground(s) for representation *(please read guidance notes 1 & 2)*

On behalf of the Chief Officer of Police, I am writing to lodge a representation of the above application on the following grounds:

- 1) The prevention of Crime and Disorder
- 2) Public Safety
- 3) The prevention of Public Nuisance.

The police have concerns over the application which are detailed below.

The applicants are requesting to extend the area licensed for the sale of alcohol and late night refreshments into the external area at the front of the premises from 08 00hrs to 02 00hrs (appendix A) and if granted the removal of the existing condition stating "all activities permitted by this licence shall take place inside the Licensed Premises". The police have been in discussions with the applicants discussing the implementation of two conditions and agreeing hours for the external area of Mon to Wed 08 00 to 01 00hrs, Thurs, Fri and Sat 08 00hrs to 01 30hrs and Sunday 08 00hrs to 00 30hrs. The premises is in an area with a high amount of assorted public houses and restaurants and also many residential properties. The application has been submitted in order that the venue can try and increase their trade and compete with the neighbouring businesses by allowing customers to benefit from sitting outside for a meal or a drink in clement weather which they cannot currently offer. The police have concerns that without conditions in place there could be an increase in crime and disorder and public nuisance caused by patrons being in drink and or making excessive noise. This could impact on members of the public passing by or the nearby residents.

There is a cctv condition currently in place however we are just requesting that a more up to date condition is applied to the licence. Theoretically there is going to be an increase in trade which in turn increases the likelihood of crime and disorder. The premises currently only has to secure footage of the reception area for 31 days. We are requesting that if any incidents take place which are recorded at the venue any footage of that incident will be backed up and retained. Any footage other than in the reception area is only secured for 7 days.

There is currently only one nearby venue which still has tables and chairs outside in the early hours of the morning and we have requested that the venue adjust the requested opening hours to ensure that there is no real increase to nearby residents caused by noise. The venue currently have a 24 hour licence so they are still able to supply alcohol and late night refreshments to their patrons however this will need to take place within the venue. I do not feel it necessary for patrons to be outside the venue until 02 00hrs and the slight amendment to the requested hours should have no real impact on them. Unfortunately we have not managed to come to an agreement in the time allowed and so



HAMPSHIRE CONSTABULARY



**NEW GRANT OR VARIATION OF PREMISES LICENCE
OR CLUB PREMISES CERTIFICATE
FORM FOR REPRESENTATIONS FROM HAMPSHIRE CONSTABULARY**

respectfully request that the committee make the decision with regards to the variation.

State any conditions that the Police seek to negate the need for a hearing

Outside Checks

The Designated Premises Supervisor shall ensure that any patrons using the outside licensed area at the front of the premises after 22 00hrs do so in an orderly manner and are supervised by staff so as to ensure that there is no public nuisance. Checks are to be made at 30 minute intervals and records are to made and should be available for inspection by Hampshire Constabulary and any responsible authority. The records should be retained for a period of 3 months.

CCTV

The premises shall have sufficient cameras located within the premises to cover all public areas including outside of the premises covering the entrance and exit. The system will be able to cope with strobe lighting (where used) and all levels of illumination throughout the premises as well as outside areas.

CCTV warning signs to be fitted in public places.

The CCTV system must be operating at all times whilst the premises are open for licensable activity. All equipment shall have a constant and accurate time and date generation.

The recording system will be able to capture a minimum of 4 frames per second and the recordings of the reception area shall be kept for a minimum of 28 days.

Records must be made on a weekly basis and kept for inspection to show that the system is functioning correctly and that data is being securely retained.

The DPS or premises manager must be able to demonstrate that the CCTV system has measures to prevent recordings being tampered with, i.e. password protected.

There shall be sufficient members of trained staff at the premises during operating hours to be able to provide viewable copies immediately to police on request when investigating allegations of offences or criminal activity. Any images recovered must be in a viewable format on either disc or VHS. Footage supplied in a digital format on CD or DVD will also have a copy of the CCTV system software enabled on the disc to allow playback.

In the event of technical failure of the CCTV equipment the Premises Licence holder/DPS MUST





HAMPSHIRE CONSTABULARY



NEW GRANT OR VARIATION OF PREMISES LICENCE OR CLUB PREMISES CERTIFICATE FORM FOR REPRESENTATIONS FROM HAMPSHIRE CONSTABULARY

report the failure to the Hampshire Western Police Licensing Unit within 24 hours.

Where a record is made of any incident at the premises the licence holder will ensure that any footage from the premises CCTV system covering the incident is backed up and retained for 12 months.

IT IS AN OFFENCE, UNDER SECTION 158 OF THE LICENSING ACT 2003 TO MAKE A FALSE STATEMENT IN OR IN CONNECTION WITH THIS REPRESENTATION

Part 3 – Signatures *(please read guidance note 3)*

Recommendation of Police Officer

Signature of Police Officer Completing

Signature: 

PC 21071

Date: 10/10/13

Recommendation of Police Sergeant

Signature of Police Sergeant





HAMPSHIRE CONSTABULARY

G88

Page 5 of 5



NEW GRANT OR VARIATION OF PREMISES LICENCE OR CLUB PREMISES CERTIFICATE FORM FOR REPRESENTATIONS FROM HAMPSHIRE CONSTABULARY

Signature:



Date:

10/10/13

Decision of Police Licensing Inspector

Signature of Police Licensing Inspector

Signature:

Date:

NOTES FOR GUIDANCE

1. The ground(s) for representation must be based on one of the licensing objectives.
2. Please list any additional information or details, for example dates of problems which are included in the grounds for representation if available.
3. The representation form must be signed.



From: Montague, Hayley on behalf of Licensing
Sent: 01 October 2013 20:54
To: [REDACTED]
Subject: RE: objection to Application to vary a premises License - Genting Club

Attachments: ufm2.doc

Dear Mr. Riley,

Please find attached an acknowledgement letter regarding your below representation.

Kind regards,

Hayley Montague
Licensing Enforcement Officer
Legal, HR and Democratic Services
Southampton and Eastleigh Licensing Partnership
Southampton City Council

Tele: 023 8083 2421
Fax: 023 8083 4061
E-mail: hayley.montague@southampton.gov.uk
Web: www.southampton.gov.uk/licensing
Post: Licensing - Southampton City Council
PO Box 1767, Southampton. SO18 9LA

Please note:- This email is confidential but may have to be disclosed under the Freedom of Information Act 2000, the Data Protection Act 1998 or the Environmental Information Regulations 2004. SCC does not make legally binding agreements or accept formal notices/proceedings by email. Emails may be monitored. This e-mail (and its attachments) is intended only for the use of the person(s) to whom it is addressed and may contain information which is privileged and/or confidential. If it has come to you in error you must take no action based on it, nor must you copy or show it to anyone.

From: [REDACTED]
Sent: 01 October 2013 15:17
To: Licensing
Subject: objection to Application to vary a premises License - Genting Club

Dear Sirs

I would like to object to the application – to extend the licence into an external area to the front of the premises to permit the sale of alcohol and the provision of late night refreshment

I expect that this application is to serve into the early hours of the morning, which will increase the already high volume of noise that their customers make when leaving the premises at any time of the night right down to 6am.

It is a partially residential area who put up with a great deal that comes out of the Casino. The noise levels around the area do seem to stem from the casino's late night visitors

It will also have an impact on the traffic/parking in the area as the proposed site is already used as a car park and is always full until the early hours.

Coupled with the proposed plan to get rid of some parking on Terminus terrace for a taxi rank is going to make the area intolerable to live on

David Riley
2 Terminus Terrace
Southampton
SO14 3DT
02380 710652

2000, the Data Protection Act 1998 or the Environmental Information Regulations 2004. SCC does not make legally binding agreements or accept formal notices/proceedings by email. Emails may be monitored. This e-mail (and its attachments) is intended only for the use of the person(s) to whom it is addressed and may contain information which is privileged and/or confidential. If it has come to you in error you must take no action based on it, nor must you copy or show it to anyone.

From: Residents Association South Western House [REDACTED]

Sent: 07 October 2013 19:07

To: Licensing

Subject: Casino at Terminus Terrace Application

Dear Sir

I am writing on behalf of the residents of South Western House, as a director of the RTM Co Ltd.. Our building, with 110 apartments, is adjacent to the Genting Club and we are already having to contend with a huge amount of noise pollution from all the restaurants, clubs and pubs around the top end of Oxford Street. In addition, our private parking spaces are constantly being compromised by unauthorised vehicles whose drivers are looking for free and convenient parking. As such, I strongly object to the application to use half the casino's carpark for seating with a licence to sell alcohol and refreshments outside until 2am as I feel this will add greatly to the problems outlined above.

Please ignore an earlier e-mail which came from my icloud account - I was still amending it when I inadvertently touched the send button. Many apologies.

Yours faithfully

Sonja Angus

For SWH RTM Co Ltd

From: Sonja Angus [REDACTED]
Sent: 08 October 2013 20:22
To: Licensing
Subject: RE: Casino at Terminus Terrace Application
Dear Hayley

My address is 108 Imperial Apartments, South Western House, Southampton, SO14 3AL.

Thank you for pointing that out.

Kind regards

Sonja Angus

For SWH RTM Co Ltd

Licensing <Licensing@southampton.gov.uk> wrote:

Dear Ms. Angus,

As required by the Licensing Act 2003 please provide your address so that we can validate your below representation.

I note that you are also writing on behalf of the residents of South Western House, in order to accept the representation as being on their behalf please provide the names and addresses of those whom you represent and their consent to being represented by you. Further information on representations can be found on our web pages, available via the following link:
<http://www.southampton.gov.uk/business/licensing/alcohol-licences/representations.aspx>.

Kind regards,

Hayley Montague

Licensing Enforcement Officer

Legal, HR and Democratic Services

Southampton and Eastleigh Licensing Partnership

Southampton City Council

Tele: 023 8083 2421

Fax: 023 8083 4061

E-mail: hayley.montague@southampton.gov.uk

Web: www.southampton.gov.uk/licensing

Post: Licensing - Southampton City Council

PO Box 1767, Southampton. SO18 9LA

Please note:- This email is confidential but may have to be disclosed under the Freedom of Information Act

This page is intentionally left blank